

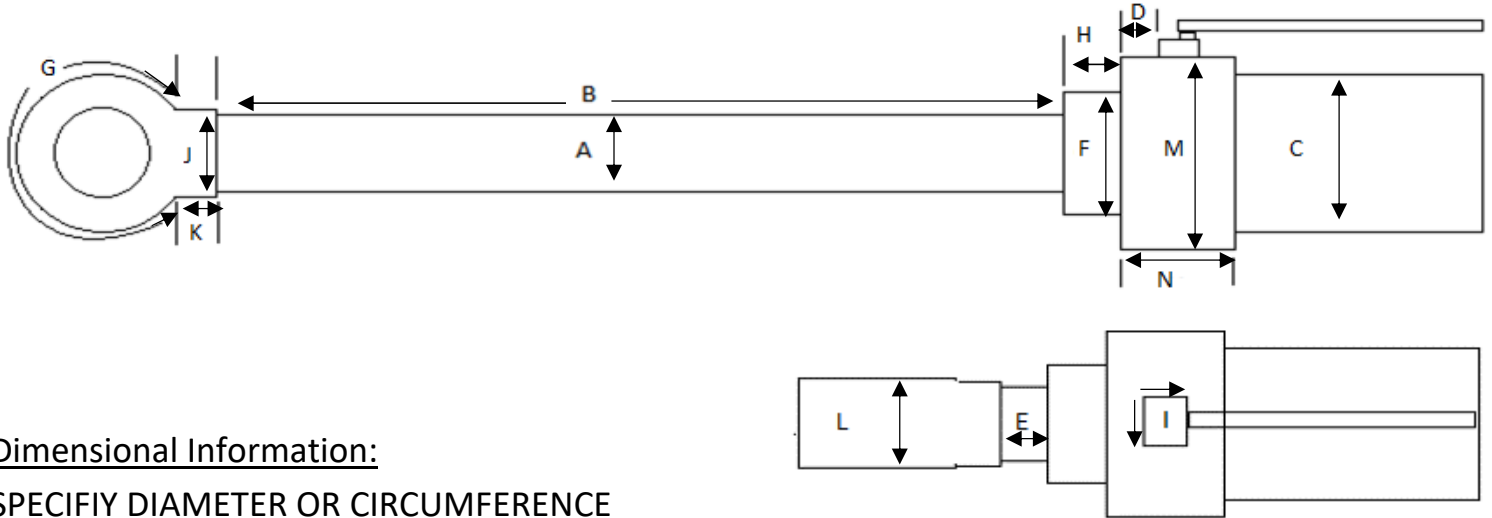

Company Name: \_\_\_\_\_ P/N: \_\_\_\_\_

Machine Description, Make, Model: \_\_\_\_\_

Cylinder Application/Action: \_\_\_\_\_



**Dimensional Information:**

**SPECIFY DIAMETER OR CIRCUMFERENCE**

A	_____	H	_____
B	_____	I	_____
C	_____	J	_____
D	_____	K	_____
E	_____	L	_____
F	_____	M	_____
G	_____	N	_____

If there are any brackets, guards, multiple lines, levelers, Z-bars, etc., on your cylinder, please draw them into the diagram.

Materials - Choose One:

Ballistic Nylon	_____
Kevlar	_____
Silica (heat only)	_____

**Notes:**

I\* - This is the dimension around the housing/manifold/nut where it is bolted/welded to the cylinder. NOT the line OD.  
 G dimension can be given 2 ways. The OD across the rod eye, or the distance around the outside of the rod eye. Please note which is given.

**When measuring your cylinder:**

1. Be as precise as possible. Do not round, guess, estimate.
2. Millimeters are preferred. If measuring with inches do not round up more than to the next 1/8".
3. Fill the sheet as completely. Do not skip any requested dimensions.
4. It is assumed that cylinder shape is round. If your cylinder head/clevis/gland is not round, you MUST note the shape and how the dimensions are being given. If you do not, the boot will not fit your cylinder correctly.

Please refer to our "CONTACT US" website page for local fax numbers or email

[sales@redwoodplastics.com](mailto:sales@redwoodplastics.com)  
[www.redwoodplastics.com](http://www.redwoodplastics.com)

