

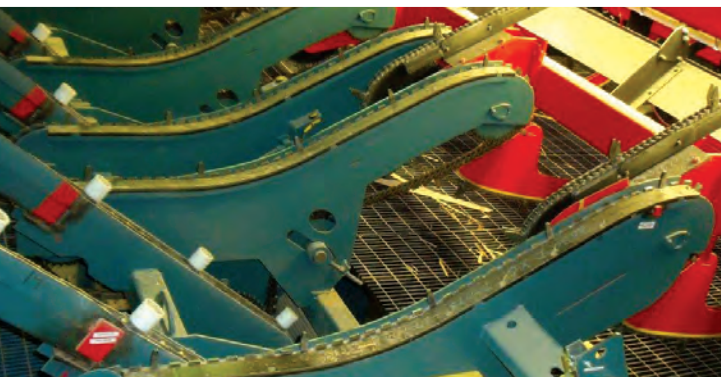

# REDWOOD

PLASTICS AND RUBBER



**MAKE. CREATE. INNOVATE**







## BRINGING SOLUTIONS TO OPTIMIZE PRODUCTION IN THE FORESTRY INDUSTRY SINCE 1971

Redwood Plastics and Rubber was the first to bring wear solutions to the forestry industry. Solutions such as **wear strip**, **kiln cart bushings** and **impact pads** were just some of the initial products that paved the way for the hundreds of products that are used today.

**Redco™** plastics and rubber products have been proven to decrease downtime, and reduce noise, vibrations and power consumption. Increase production to its fullest potential by adding **Redco™** plastic and rubber products; bringing benefits and savings to your site.

Redwood Plastics and Rubber specializes in a variety of applications including; shaft bearings, chip screens, channel, sheaves and conveyor liners. Replacing traditional materials with **Redco™** plastics and rubber products has never been so easy with the varieties now available.

Cut costs, reduce wear and increase productivity. Contact us today.



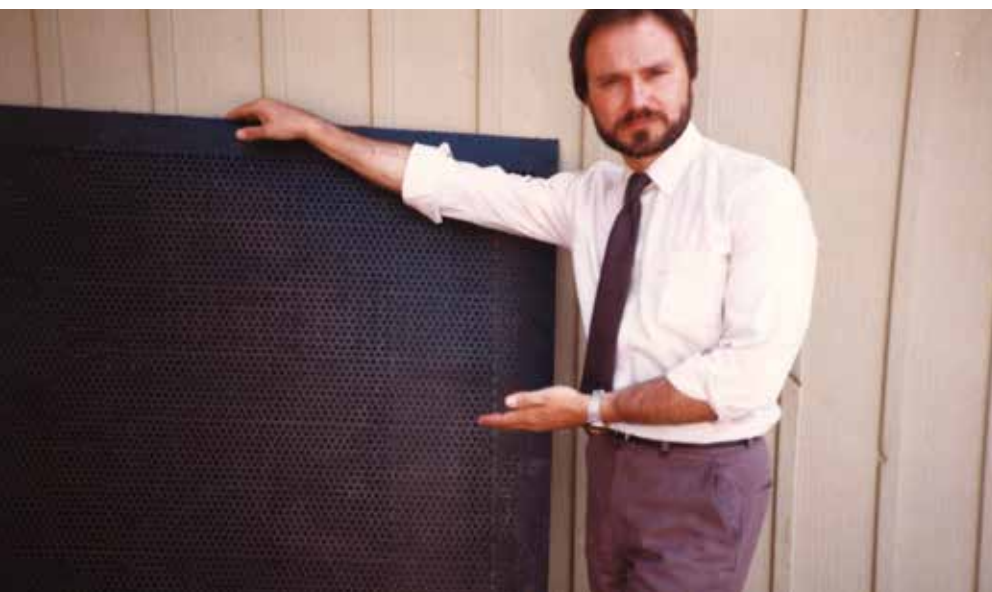

For more information on Redco™ products please call: 1 833 381 1195

## Table of Contents

REDCO MATERIALS SUMMARY	7
UHMW LINER INSTALLATION GUIDELINES	12
WELD WASHER INSTALLATION	14
BUSHINGS & BEARINGS	15
KILN CART BUSHINGS	18
S.N. BEARING INSERTS	20
IDLER SPROCKETS	21
SNAP IT SPROCKET	22
DEADPLATE BUMPERS & PADS	23
SHARP CHAIN BED	25
DISSIPATER CHANNEL	25
FLANGE CAP	26
CHAIN CHANNEL	27
CHAIN CHANNEL INSERTS	28
CHANNEL PROFILES	29
OREGON BENDS	30
750 CHANNEL/ANGLE	31
UHMW/PE CONVEYOR LINERS	32
SYNSTEEL CONVEYOR LINERS	33
SAW BLADE CARRIERS	34
UHMW WEARPLATE	35
CONVEYOR FLIGHTS	36
SAW GUIDES	38
CARRY-OVER WHEELS/ LUG LOADER	39
9600 IMPACT BEARINGS	40
J-HOOKS/SORTER HOOKS	41
SLIDER BLOCKS	43
SPLIT BEARING BLOCKS	44
PUSHER LUGS	45
DIVERTER ARMS	47
NYLON SHEAVES	48
ROLLER NOSE DIVERTER GATES	49
TRIMMER LUGS	50
CARRIAGE WHEELS	51
SWITCHSAFE™ - CHIP N' SAW KNIFE TOOL	52



## Table of Contents Cont.

CHAIN CAP	53
HOSE PULLEYS	53
V-BELT SHEAVES	54
HANGER BEARINGS	55
RUBBER & URETHANE ROLLERS	57
SHARK FIN BOARD TURNER	59
FRP STRUCTURAL; HANDRAILS, LADDERS, SHAPES & PLATE	60
FRP GRATING	61
PVC STRIP DOOR	63
SAWMILL APPLICATION/PRODUCT LIST	65
PULP AND PAPER APPLICATION/PRODUCT LIST	71
BIOMASS APPLICATION/PRODUCT LIST	75

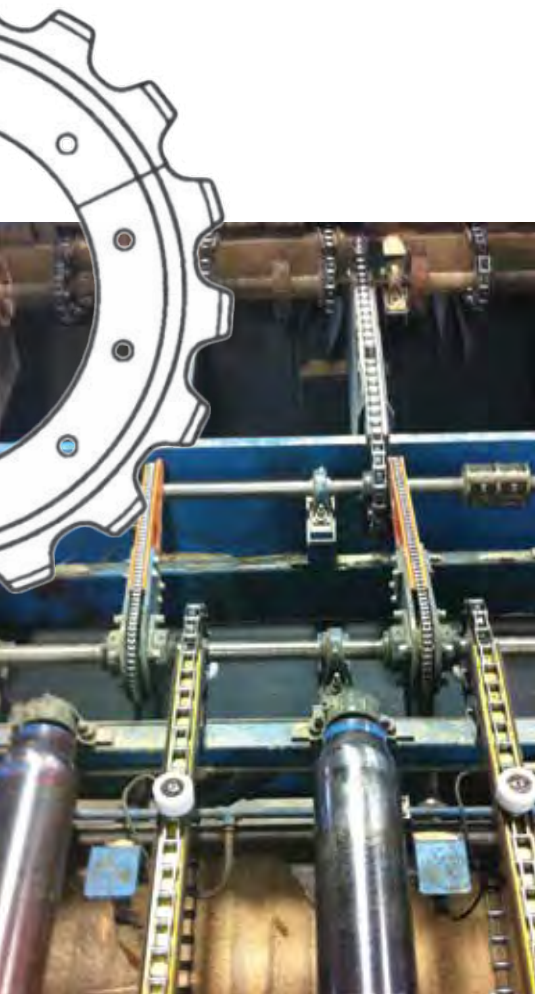

# Redco™ MATERIALS

Redwood Plastics and Rubber manufactures and distributes a wide variety of plastic and rubber materials. Please visit our website for a complete list of standard and premium materials.



## Redco™ UHMW

### Ultra High Molecular Weight Polyethylene

With a low coefficient of friction, superior abrasion and corrosion resistance, Redco™ UHMW has been proven to outlast mild and hardened steel by as much as 10 to 1. Redco™ UHMW is ideally suited for a variety of applications to remedy material hang-up and accelerated wear due to abrasion or corrosion. It also has no moisture absorption.

In addition to our virgin grade we offer a number of specialty grades for demanding applications including:

### REDCO™ TITANIUM

THE ULTIMATE ARMOR - Specially formulated to be the slickest, strongest, and toughest UHMW. Offering the lowest coefficient of friction, excellent dimensional stability, and impact resistance.

### REDCO™ REPROCESSED UHMW

An environmentally friendly plastic for wear parts and components. An amazingly tough material with a low coefficient of friction, wear resistance, and impact strength.

### REDCO™ SYNSTEEL

PULP FRIENDLY - Metal filled UHMW offering superior abrasion resistance, with improved dimensional stability and the highest load bearing capability of any UHMW.

### Other REDCO™ UHMW Specialty Grades:

Redco™ Tivar®\* (Dryslide, H.O.T, Burnguard™\*, Tivar88®\*, Ceram P), Redco™ X-Static, Redco™ Matrox™\*\*, Redco™ Polystone®\*\*, Redco™ HiViz, Redco™ Sure Glide and Redco™ Rocketplate.

**Other materials available:** HDPE (High-Density Polyethylenes), LDPE (Low-Density Polyethylenes), VHMW (Very-High Molecular Weight Polyethylene) and Polypropylene.

\*TIVAR and Burnguard are registered trademarks of the Quadrant Group of Companies.

\*\*Matrox and Polystone are registered trademarks of Röchling Engineered Plastics.

## Redco™ POLYURETHANE

Redco™ Polyurethane offers remarkable abrasion resistance and outstanding durability in shock, vibration, and impact applications, outlasting rubber and metal by up to 20 to 1.

With our extensive design capabilities and Redco™ Polyurethanes' ability to range in hardness from eraser soft to bowling ball hard, this material can be used for an infinite number of applications. Some specialty grades include:

### REDCO™ DEADPLATE

MAXIMUM ENERGY ABSORPTION - A modified polymer with the lowest rebound characteristics of any polyurethane.

### REDCO™ SPS2000

KRAFT MILL PULP FRIENDLY - Enhanced polymer that has improved sliding capabilities increasing product flow in material handling applications.

### REDCO™ 750XL & 750SXL

PREMIUM BEARING MATERIAL - Outperforms and outlasts conventional materials in bearing applications. (up to 2,500 P.S.I.)

### REDCO™ S.V.I PADS

SHOCK, VIBRATION, ISOLATION - Developed to control vibration and impact to reduce noise and absorb energy. Lessens the peak forces or shock transmitted into a supporting structure.



## HARDNESS COMPARISON CHART

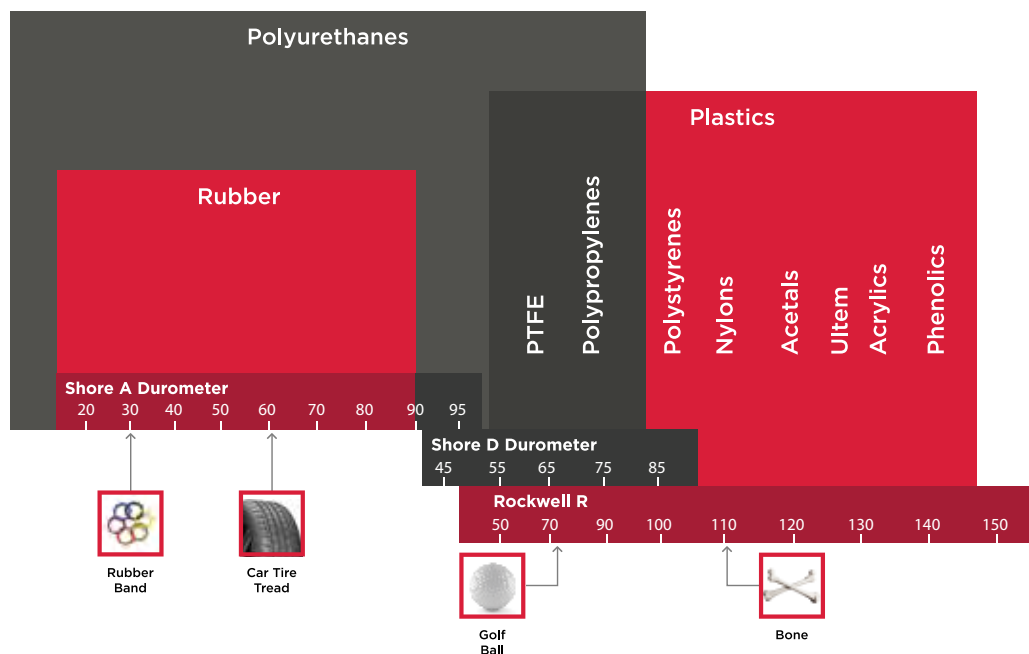





## Redco™ NYLON

Offering high load bearing capabilities (up to 4000 P.S.I), Redco™ Nylon is light weight, and self lubricating with a low coefficient of friction. It is a diverse material that performs very well in applications where heat and load have caused other materials to crack or break.

Redco™ Nylon has excellent durability and can also be formulated to withstand heat up to 260°F (128°C). Redco™ Nylon is easily machined and is an outlasting, outperforming replacement for parts traditionally made of metal.

## Redco™ ACETAL & PET

Redco™ Acetal & Redco™ PET brings together the benefits of strength, stiffness, low coefficient of friction, and dimensional stability providing a versatile and easily machinable material that exceeds the life of many parts that are traditionally metal.

Redco™ PET is a popular within the food and beverage industry. PET is preferred in applications because of its strength, thermo-stability and transparency. It also withstands environments with a constant temperature of up to 230°F and is not affected by frequent chlorine wash downs.

Redco™ Acetal is suited for a variety of industries and applications. It acts as an electrical insulator, is FDA Approved for food applications and is an excellent material for use in applications requiring close-tolerances. Acetal withstands environments with a constant temperature up to 180°F.

## Redco™ RUBBER

Redco™ Rubber is available in a wide variety of grades for applications requiring excellent chemical resistance and superior tensile strength. Varieties include; Natural (NR), Styrene-Butadiene (SBR), Neoprene (CR), Butyl (IIR), Ethylene-Propylene-Diene (EPDM), Red Sheet Packing and Hypalon.

Processing techniques are available to mold, extrude, and cast to best suit your application.

## Redco™ CLEAR & TRANSPARENT

### See-Through Materials

Materials such as Redco™ Acrylic and Redco™ Polycarbonate are available in both transparent, translucent, and tinted varieties. See-through materials are lightweight with outstanding weatherability, high impact resistance, excellent thermoforming, and good machinability.

Redco™ High Performance fluoropolymers such as FEP also have excellent clarity.

## Redco™ FRP

### Fiberglass Reinforced Polymer

Redco™ FRP provides durability with extremely high strength. It is corrosion resistant and non-conductive making it ideal for applications in damp environments or where an electrical current or chemicals (either acidic or caustic) may be present

Redco™ FRP is a low maintenance, lightweight material with added UV resistance. Available in various grades of grating as well as structural shapes and plate, ladders, cages and wall panels.

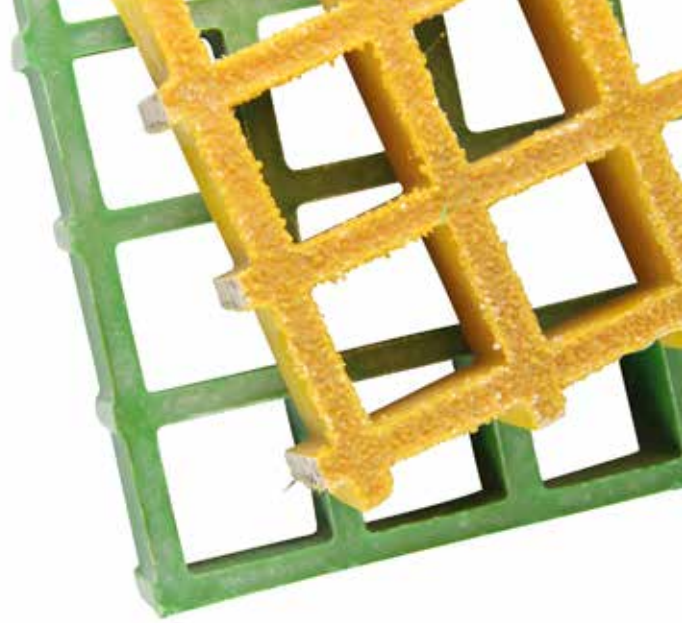

## Redco™ INDUSTRIAL LAMINATES

Redco™ Laminates are the strongest and toughest materials in our product line. Redco™ Laminates have excellent compressive strength (up to 70,000 P.S.I), incredible impact strength, and high load bearing properties.

Redco™ Laminates are available in many different grades and types with a variety of fillers including; glass, paper, cotton, melamine, silicone, and polyester.

## Redco™ PTFE

Redco™ PTFE offers outstanding properties making it the ultimate choice for a magnitude of applications. Redco™ PTFE has no water absorption and is self lubricating with excellent chemical resistance and high temperature tolerance (+500°F/260°C). It also has the lowest coefficient of friction of any other plastic variety.

**Other materials available:** PVDF (Poly-Vinylidene Fluoride), Fluorosint, FEP (Fluorinated Ethylene Propylene), PCTFE (Polychlorotrifluoroethylene), and ECTFE (Ethylene-Chlorotrifluoroethylene).

Custom filled materials are also available for enhanced physical properties.

## Redco™ HIGH PERFORMANCE

Redwood Plastics distributes a wide variety of plastic grades to handle the most challenging applications. These plastics materials were developed for applications/environments with high heat, heavy loads, and corrosive chemicals.

**Materials Available:** Ultem®, Torlon®, Radel, Peek®, Ertalyte-tx Fluorosint®, Duratron®, Celazole, Semitron®, PC 1000, Polycarbonate, PVDF, Victrex® and Kytac.



## Redco™ LINERS

Redco™ Lining Systems promote reliable, steady bulk material flow, with durable materials that are impervious to abrasion, chemicals, and corrosion.

Reduces or eliminates arching, ratholing, and erratic flow to get your materials moving. Lining applications are available for trucks, hoppers, bins, bunkers, chutes, silos, and many more.

### REDCO™ UHMW

Offers a combination of excellent machinability and low surface friction with outstanding wear and corrosion resistance. FDA & USDA approved, Redco™ UHMW reduces material hang ups and enhances material flow, increasing your production and your profits.

### REDCO™ POLYURETHANE

Designed for use in impact, abrasive, low temperature, and gritty environments – especially where impingement is involved. Redco™ Polyurethane is a material with elasticity and memory that is available in a large range of hardnesses. Ideal in locations where material impact and directional changes are causing excessive wear or material deflection is required.

### REDCO™ POLYURETHANE COATINGS

Polyurethane coatings are a cost-effective coating option for a variety of substrates.

### REDCO™ CERAMIC LINERS

Ceramic Liners exponentially outlast UHMW and urethane in pure sliding wear applications. Ceramics have incredible tensile strength and hardness with industry leading abrasion resistance in both wet and dry applications.

### REDCO™ RUBBER

Rubber wear liners reduce corrosion and abrasion and can also offer thermal insulation, chemical resistance and electrical isolation.



#### Other materials available:

X-Static, Tivar® 88\*, Tivar® 88-2\*, Tivar Dryslide, Burnguard™\*, Tivar® H.O.T, Tivar® Ceram P®, Quicksilver®, Redco™ Matrox™\*\* and Durapro.

\*Tivar, Quicksilver and Burnguard are a registered trademarks of the Quadrant Group of Companies.

\*\*Matrox is registered trademark of Röchling Engineered Plastics.



## Redco™ UHMW LINER INSTALLATION GUIDELINES

**Redco™ UHMW** is lightweight ( $\frac{1}{4}$ " thick x 4'x10' sheet and weighs approximately 50 lbs.) and can be handled by one or two people. It can be cut and drilled with normal metal or woodworking tools.

It is important that **Redco™ UHMW** be securely fastened to the substrate. The linear expansion (.00013" per inch / per degree C.) creates a force that moves the sheet. Proper spacing of fasteners according to the sheet thickness will overcome this force and hold the sheet flat against the substrate.

For all thicknesses, fastening devices should be no further than 2" from any edge. It is important to tighten fasteners to hold the liner securely against the substrate.

The correct spacing and strength of the fasteners will minimize the warpage due to its linear thermal expansion properties. Where two sections are joined, butt the edges together as tightly as possible.

To allow for the linear expansion and contraction, we recommend the following joining methods for **Redco™ UHMW** sheet:

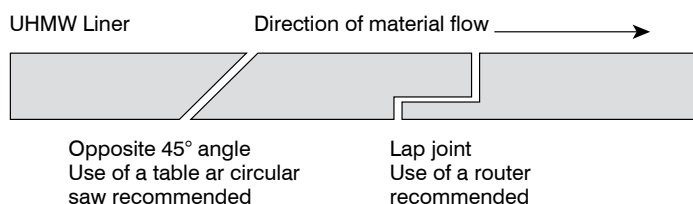

Use a bolt with a diameter similar to the drilled hole. The diameter of the hole should be a minimum of  $\frac{1}{8}$ " larger than the bolt size. The bolt head should have a washer to prevent pull-out.

Improper fastening will result in surface ripples and gaps where sections are joined. Surface ripples will show excessive wear. Material temperature should be 20° - 24° C. during installation.

It is recommended that sheets be held in place with mechanical fasteners. Correct spacing of fasteners is in relationship to the thickness of sheet.

Sheet Thickness	Recommended Spacing of fasteners ( on centers)
$\frac{1}{4}$ "	6" - 8"
$\frac{3}{8}$ "	8" - 10"
$\frac{1}{2}$ " / $\frac{5}{8}$ " / $\frac{3}{4}$ "	12" - 15"
1" and over	5" - 20"

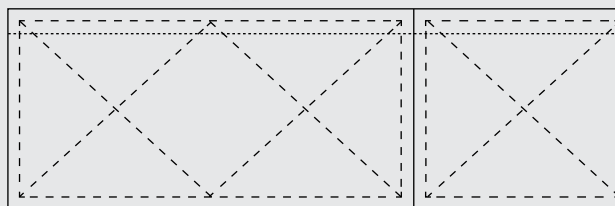



# Redco™ UHMW LINER INSTALLATION GUIDELINES

**ELEVATOR BOLTS** are very popular fasteners. The most common size is 1/4". These bolts have a flat head that can be countersunk into 3/8" thick sheets or can be flush mounted on 1/4" thick sheets. They give maximum holding power and are easy to install and remove when replacing the liners. Bolt diameters 1/4", 5/16" and 3/8" are available in lengths from 3/4" to 2-1/2".

**STAINLESS STEEL FLATHEAD BOLTS** offer better abrasion and corrosion resistance and are preferred over mild or carbon steel bolts. The flathead shape allows the bolt to be flush with the surface. Liners are easy to install and remove when replacement is necessary. These fasteners are normally used to hold thicker sheets (from 3/8" to 1" thick).

**DRIVE RIVETS** are used for blind fastening to metal and less dense materials such as wood. The correct size rivets are selected according to the combined thickness of the sheet and substrate. Rivets are placed in pre-drilled holes and struck with a hammer. The rivet will flare out and secure the **Redco™ UHMW** to the substrate. This method is very fast, effective and ideal for blind fastening or "hard to reach" areas.



**GENERAL:** For chains that run in one direction a wear strip may be fastened at the drive end and allowed to float. Remember to allow for expansion. **Redco™ UHMW** will degrade in direct sunlight. Use caution when installing in outdoor applications.

## SUGGESTED FASTENING METHODS

### NUT & BOLT

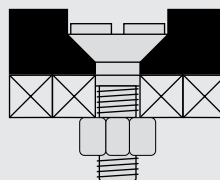

### CUTTER

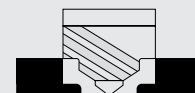

1. DRILL FASTENER HOLE IN UHMW MATERIAL WHERE CONVENIENT

### ELEVATOR BOLTS

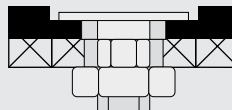

### WASHER



2. HOLD THE MATERIAL IN PROPER POSITION

### DRIVE RIVETS

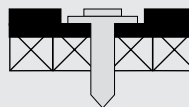

### WELD, SCREW RIVET, NAIL



3. CENTER THE WASHER TO ALLOW THE MAXIMUM MOVEMENT IN ALL DIRECTIONS

### ELEVATOR BOLTS

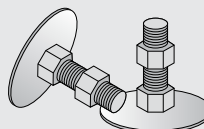

### STAINLESS STEEL FLATHEAD BOLT





# Redco™ WELD WASHER/SPADE BIT

## INSTALLATION RECOMMENDATIONS

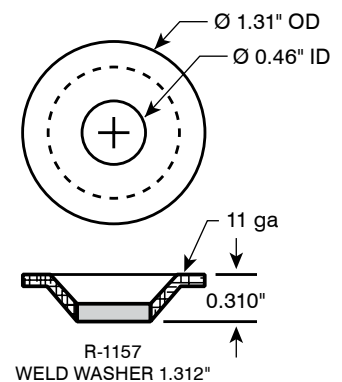
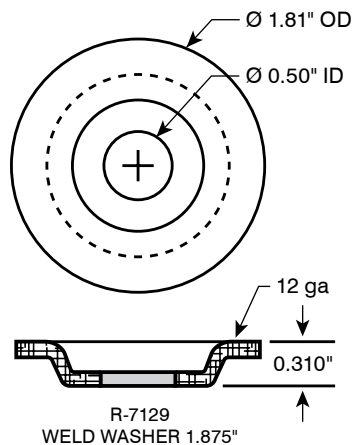
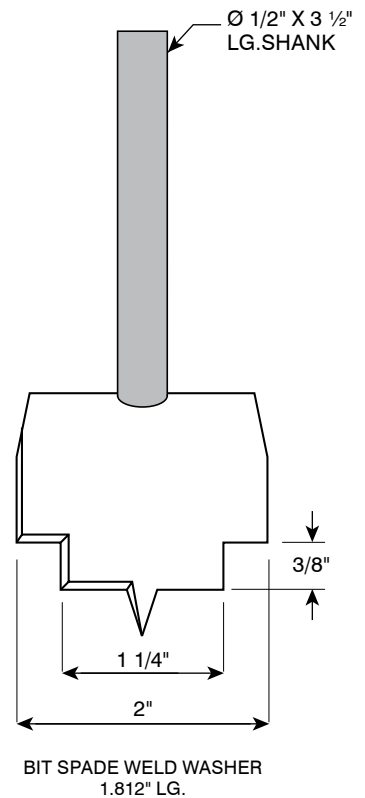
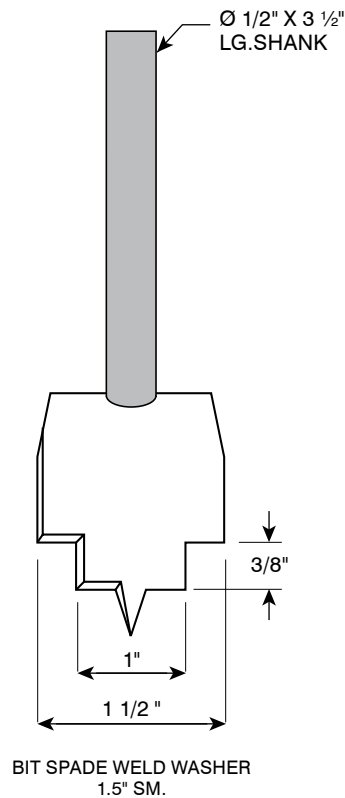
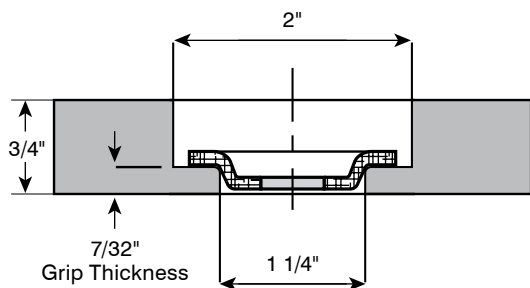
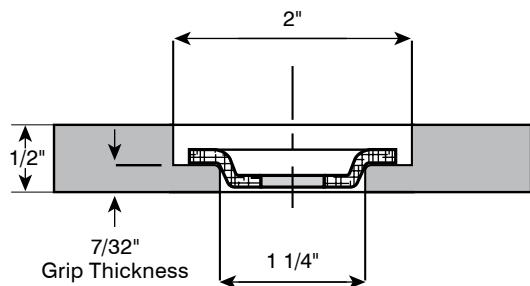
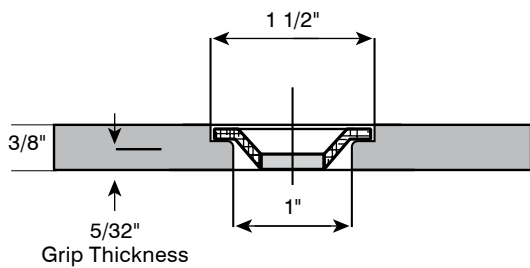

### Installation Recommendations

- 18" - 12" c/c typical
- 12" c/c for cold climate installations
- Other fasteners available upon request



# Redco™ BUSHINGS & BEARINGS MATERIALS

Durable polymers capable of performing better than brass, bronze or babbitt bearings.

- Self Lubricating
- Excellent for impact and shock applications
- Exceptional wear life and resistance to corrosion
- Low temperature resistance to -80°F



When it comes to using plastics for various applications, it may be difficult to determine which material to use, especially in bearing and bushing applications. Contact us for help in choosing which **Redco™** material is most optimal.

## MATERIAL

### Redco™ POLYURETHANES

### Redco™ Polyurethane 750 / 750 XL / SXL

### Redco™ CAST NYLONS

### Redco™ ACETAL

## WHEN TO USE Redco™ BEARING MATERIALS

- Applications where shock, vibration, impact and lower or freezing temperatures are a concern.
  - Urethane is better here due to its elasticity.
  - Absorbs 1.3% moisture.
- 
- Approx. 2500 PSI is at the top of its limitations.
  - Typically used as: Hourglass Bearings, Sprocket Bushings, Kicker Arm Bushings, Pivot Bearings, SN Bearings Inserts, Rollers, Barker Bearings, and Hanger Bearings.
- 
- Applications of higher velocity, pressure and ambient temperature (will not take a lot of cold and impact).
  - Absorbs 3% moisture.
  - Approximately 4000 PSI is at the top of its limitations.
  - Typically used as: Kiln Wheel Bearings, Pivot Bearings, Sheaves, Winch Bushing, Tail Shaft Bearings, and Hanger Bearings
- 
- Similar to nylon but slightly harder with considerably less moisture absorption.
  - Approximately 4000 PSI is at the top of its limitations.
  - For use in submerged or high moisture environments.
  - Excellent machinability.

# BEARING CLEARANCE TABLES

**Table A - SHAFT RUNNING CLEARANCE**

If the shaft diameter in inches is:	1	2	3	4	5	6	7	8	9	10	11	12
Clearance in inches is:	.007	.010	.013	.015	.018	.020	.022	.024	.026	.028	.030	.032

**Table B - BEARING WALL EXPANSION CLEARANCE (only for normal operating temperatures)\***

If the bearing wall thickness is:	1/8	1/4	3/8	1/2	5/8	3/4	7/8	1	1 1/4	1 1/2	1 3/4	2
Clearance in inches is:	.002	.004	.006	.008	.010	.012	.015	.017	.020	.024	.028	.033

**Table C - PRESS FIT INTERFERENCE CLEARANCE (only if press fit)**

If housing I.D. in inches is:	2	3	4	5	6	7	8	9	10	11	12
Clearance in inches is:	.007	.009	.011	.012	.013	.015	.016	.017	.018	.019	.020

**Table D - MOISTURE EXPANSION CLEARANCE (only if water-lubricated bearing)\*\***

If bearing wall thickness in inches is:	1/8	1/5	1/4	3/8	1/2	3/4	1 or more
---	-----	-----	-----	-----	-----	-----	-----------

If bearing is press fit, add clearances A, B, C. Then, add the total to the shaft diameter.  
The result is the finished inside diameter of the plastic bearing.

\* - Plastics are subject to many variables (ie. Moisture, cold, heat, etc.) when being machined for specific applications.

\*\* - If lubrication is supplied to a plastic bearing the load and life are increased, dependent on the type and volume of lubricant.



## Redco™ BUSHINGS & BEARINGS Cont...

### MATERIAL

#### Redco™ PHENOLICS

### WHEN TO USE Redco™ BEARING MATERIALS

- Applications where heat, cold, high pressure, impact and velocity are of concern.
- Absorbs 1% moisture.
- Approximately 10 000 PSI is near the top of its limitations.
- Typically used as: Press Roll Bushings, Mitre Box Bushings, Sheave Bearings, High Load Kiln Bearings (30 000+), Boom Pivot Bearings, and Barker Bearings.

#### Redco™ PTFE

- Generally used in applications where extreme heat (300+°F), harsh chemicals, moisture and corrosion are of concern.
- Approximately 500 PSI is at the top of its limitations, dependent on additives.
- Absorbs virtually no moisture.
- Typically used as: Veneer Dryer Bearings, Non-stick Rollers, Food Handling and Chemical Parts.

#### Redco™ UHMW

- Application with light load, chemicals, cold, some impact.
- Absorbs no moisture.
- Approximately 500 – 800 PSI is at the top of its limitations, dependent on additives.
- Typically used as: Skate Wheels, Light Duty Bearings, Wearstrips.

**BEWARE:** Plastic clearance/tolerance is subject to many variables such as moisture, cold, and heat, when being machined for specific applications.

**\*\*Please contact us for clearances on plastic bushings or refer to the *Bearing Clearance Tables*.**

**If lubrication is supplied to a plastic bearing, the load and life are greatly increased dependent on the type and volume of lubricant.**



# KILN WHEEL BUSHINGS

## Redco™ NYLON & PHENOLIC KILN CART BUSHINGS

**Redco™ Nylon** kiln wheel bushings are heat stabilized and long-wearing to withstand high temperature environments up to 24,000 lbs per cart. High load bearing and self lubricating grades are available to suit individual applications.

For use with loads in excess of 30,000 lbs per cart; self lubricating **Redco™ Phenolic** is the most optimal material for bearings and bushings.

Bushings are available in a variety of sizes and grades.

- Rust Resistant
- Heat Stabilized
- Impact Resistant
- Self-Lubricating
- Non-Corrosive
- No Galling



## DID YOU KNOW?

In 1972, Redwood Plastics and Rubber installed the first Redco Nylon Kiln Cart Bushings, replacing bronze bearings for longer wear life and reduced lubrication maintenance. Later, we introduced Redco Industrial Laminated Kiln Cart Bushings to withstand higher loads and higher temperatures.



## Redco™ KILN WHEEL BUSHINGS

Redco™ kiln wheel bushings are an effective way to solve the seizing problems associated with metal components.

**Nylon material:**

**Carts to 24 000/lbs (10,800 kgs)**

**Phenolic material:**

**Carts to 36 000/lbs (16,300 kgs)**

**KILN WHEEL HOUSING**

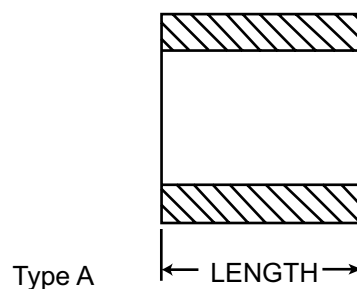
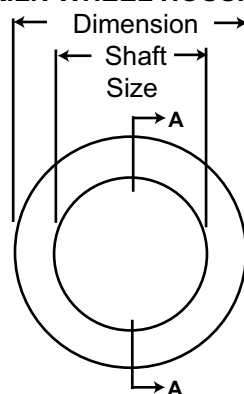

Type A

1/4" (6mm) WD x 1/8" (3mm) DP  
Grease Groove c/w 1/4" (6mm) Hole

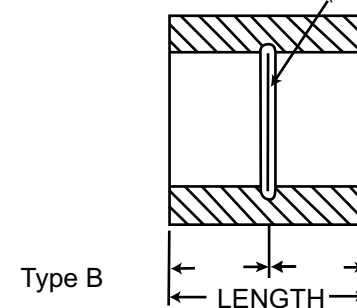

Type B

1/2" (12mm) WD. x 1/8" (3mm) DP  
Grease Groove c/w 1/4" (6mm) Hole

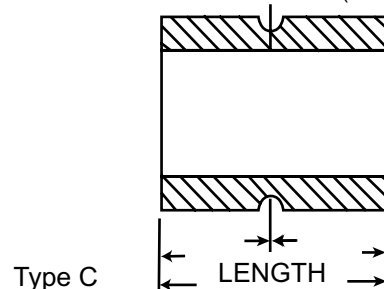

Type C

### When ordering, please specify:

1. Kiln wheel housing dimension (KWHD)
2. Shaft Size
3. Length
4. Type A, B, or C

### For Easy Ordering (Standard size)

- 2 1/4" (57mm) K.W.H.D
- 1 1/8" (29mm) Shaft
- 3 1/4" (83mm) Length

## Redco™ S.N. BEARING INSERTS

Developed as a split, quick change bearing insert for a wide-range of the various manufacturers of standard cast iron housings.



### Popular Shaft Dimensions

1 7/16" - 36.5mm
1 15/16" - 49.2mm
2 3/16" - 55.5mm
2 7/16" - 61.9mm
2 15/16" - 74.6mm
3 7/16" - 74.6mm
3 15/16" - 100mm

**NOTE: This is a floating bearing and must have a locking device when used by itself to prevent the shaft from wandering.**

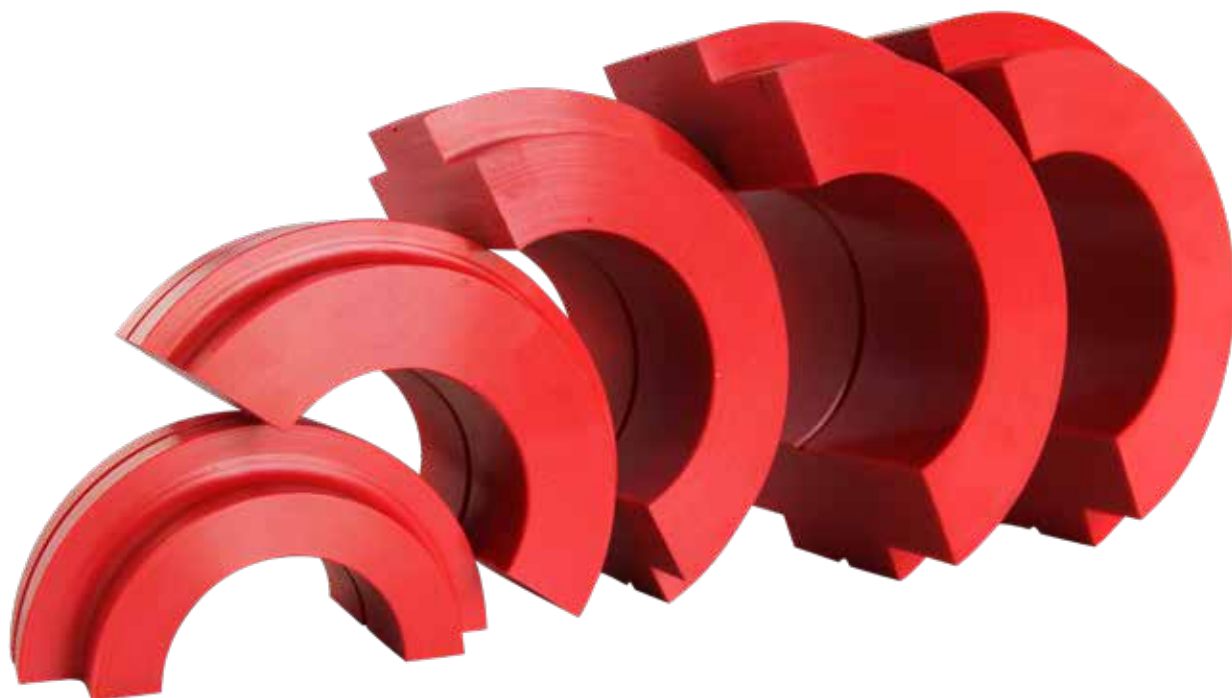



# Redco™ 750 IDLER SPROCKETS

**Redco™ 750** sprockets provides numerous advantages in a wide variety of applications. They are up to 50% lighter and significantly quieter than comparable steel sprockets, often requiring less drive power as well. The anti-corrosion quality of **Redco™ 750** sprockets results in a near maintenance-free part, with less chain wear and increased impact resistance due to their elastomeric properties - these sprockets are an outstanding value.

## Redco™ Solid Idler Sprockets

#Teeth	Pitch Dia.	Max .Bore
7	6.01"	2 3/16" - 49.2mm
8	6.82"	2 15/16" - 74.6mm
9	7.63"	2 15/16" - 74.6mm
10	8.44"	2 15/16" - 74.6mm
11	9.26"	3 7/16" - 87.3mm
12	10.08"	3 7/16" - 87.3mm
13	10.90"	3 7/16" - 87.3mm
14	11.72"	3 7/16" - 87.3mm
15	12.55"	3 15/16" - 100mm
16	13.37"	3 15/16" - 100mm
17	14.20"	3 15/16" - 100mm
18	15.02"	3 15/16" - 100mm

## Redco™ Split Idler Sprockets

#Teeth	Pitch Dia.	Max .Bore
7	6.01"	2 3/16" - 49.2mm
8	6.82"	2 15/16" - 74.6mm
9	7.63"	2 15/16" - 74.6mm
10	8.44"	2 15/16" - 74.6mm
11	9.26"	3 7/16" - 87.3mm
12	10.08"	3 7/16" - 87.3mm
13	10.90"	3 7/16" - 87.3mm
14	11.72"	3 7/16" - 87.3mm
15	12.55"	3 15/16" - 100mm
16	13.37"	3 15/16" - 100mm
17	14.20"	3 15/16" - 100mm
18	15.02"	3 15/16" - 100mm

- 81x or H78 Chain Size
- 2.609" Pitch mill sprockets
- Type C Hub
- A Plate thickness 7/8" (22mm)
- Hub diameter: 7-9 tooth 4 1/2" (114mm)  
10-14 tooth 5" (127mm)  
15-18 tooth 7" (178mm)
- Hub length through bore 3 3/4" (95.3mm)

### When ordering, please specify:

- The number of teeth
- Solid or split
- The correct shaft size
- 81X or H78



# Redco™ SNAP IT SPROCKET

## Reduce Maintenance Costs

Snap it is easy to install. No bolts, easy and quick to assemble. Simply match the arrows on the A-plate and snap together.

## Increase Production

Decrease downtime and increase profits. Interchangeable design to reduce your inventory levels. Much less expensive than split steel sprockets.

## Reduce Noise & Equipment Wear

Reduce wear on your equipment with no damage to product. **Redco™ 750** has excellent abrasion and wear resistance with high impact values. Not only is **Redco™ 750** much less expensive than steel but it also drastically reduces noise levels and has a longer wear life. No chain wear and no shaft wear. Kraft pulp mill friendly.



- Available for H-78, H-130, C-188 and 81X chains
- Compatible with split hubs and A-plates
- All hub bores are finished to size with running clearances and grease fittings
- Fits on any A-plate from 9 to 15 tooth

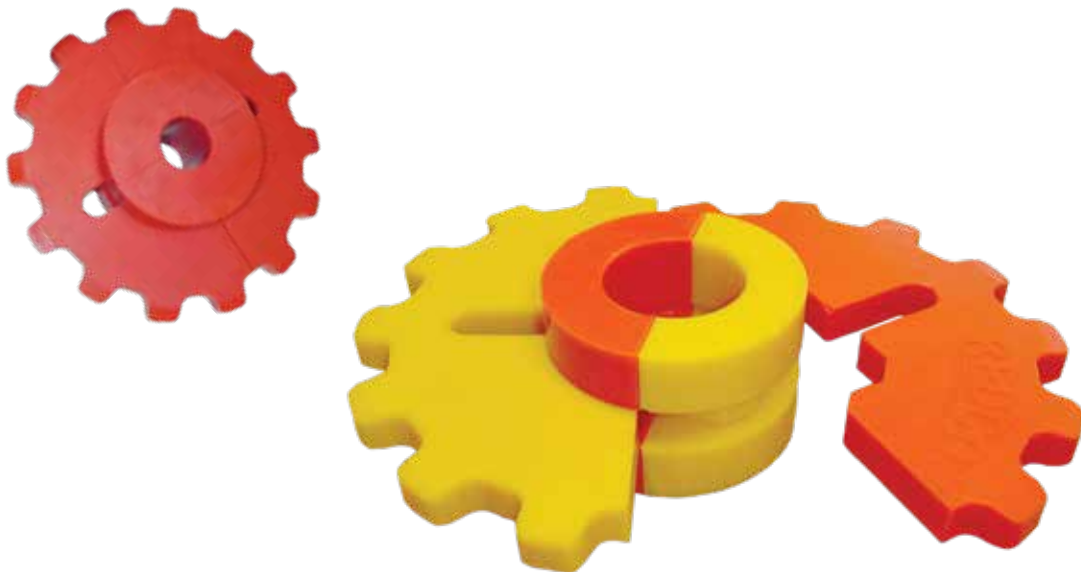



## Redco™ DEADPLATE BUMPERS & PADS

**Redco™ DEADPLATE** is a specially formulated urethane specifically designed to reduce damage to equipment in sawmills. **Redco™ DEADPLATE** is an energy absorbing elastomer and is designed to take the impact of logs and lumber as it slides down or comes into contact with machinery. This material is also ideal where product changes direction resulting in product damage or any location where "bounce" needs to be eliminated.

This protects the machinery from shock, greatly reduces rebound and has the additional advantage of reducing noise. As an elastomer, **Redco™ DEADPLATE** will always return to its original shape following impact.

- Maximum impact & shock absorption
- Reduces equipment damage
- Reduces noise and vibration
- Custom sizes and configurations are available



## DID YOU KNOW?

Impact and vibration can be devastating to equipment. In 1975, Redwood Plastics and Rubber developed Redco Urethane Impact Pads, first for lumber stops and then for many other locations to not only absorb impact but to reduce noise levels substantially and decrease product damage.







## DID YOU KNOW?

As the first UHMW extrusion company in Canada, Redwood Plastics and Rubber invented the use of UHMW as a wear strip to prevent premature wear in 1971 which paved the way to the innovation of many of the wear products we offer today.



## Redco™ Sharp Chain Bed

Made of premium **Redco™ PVM** (Pressure-Velocity-Maximum) grade cast nylon or Nylon SL, **Redco™** sharp chain bed reduces lubrication requirements approximately 75% and significantly increases the life of the chain.

The bed is precision machined to ensure maximum efficiency and is easy to install.

Chain bed is also available in **Redco™ Tivar-88**.

- Reduces lubrication requirements
- Lightweight for easy change-out
- Adaptable for single or multi strand chain

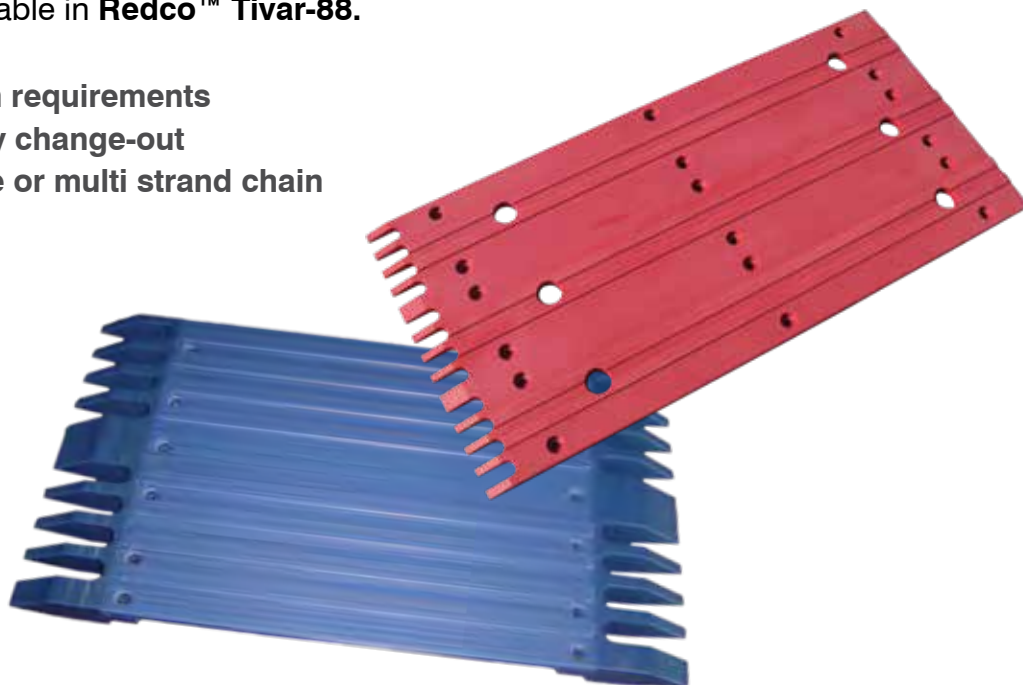

## Redco™ DISSIPATER CHANNEL

### Redco™ Log Deck Chain Channel

Helps stop the crystallization of welds and extends equipment life by absorbing shock.

Withstands logs dropping 4 to 6 feet using engineering grade **Redco™ Polyurethane**.

- Put an end to crumbling concrete foundations
- Eliminate operator booth vibration
- Extend chain and conveyor lifecycles



# Redco™ FLANGE CAP

## Redco™ UHMW Flange Cap

Commonly used in bin sorter applications, the **Redco™ Flange Cap** provides excellent protection from product damage on finished lumber.

Long-lasting with impact and abrasion resistance, the flange cap is easy to install with very low maintenance.

- **Standard Color: Yellow**
- **Fits W8 x 10 Wide Flange**

### Applications:

- **Planermill Unscrambler**
- **Planermill Sorter Bin Walls**
- **Sawmill Sorter Bin Knees**

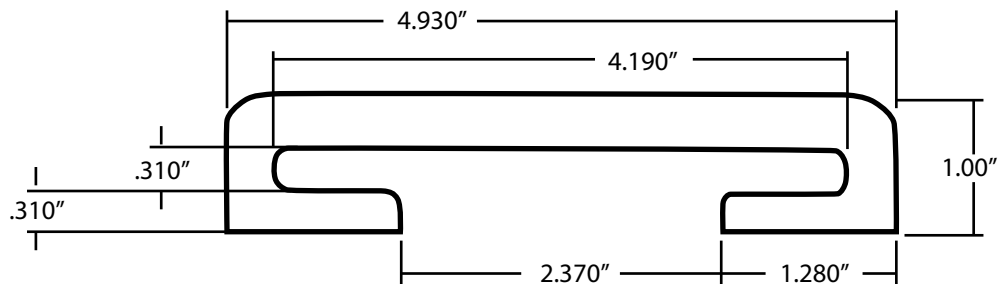



# Redco™ CHAIN CHANNEL

## Redco™ UHMW Chain Channel

**Redco™ UHMW** chain channel reduces noise and friction as well as extends the life of your chain. Chain guides are available in a variety of profiles and grades including; kraft pulp mill friendly; **Redco™ SPS2000**, **Redco™ Synsteel**, high temperature, and anti-static.

## Redco™ Titanium Chain Channel

**Redco™ Titanium** is the premium option of our UHMW formulations. It has the lowest coefficient of friction of any UHMW and the best dimensional stability. It quite simply is an overall upgrade on the traditional channel and is well worth the investment.

## Redco™ UHMW Chain Channel Inserts

These inserts simply fit into your current steel channel. Available in C3 and C4 profiles and compatible with 81x, 81xH and H78 chain. Available in **Redco™ UHMW** & **Redco™ Titanium**.

Standard and Custom Channel profiles are listed in the pages that follow.

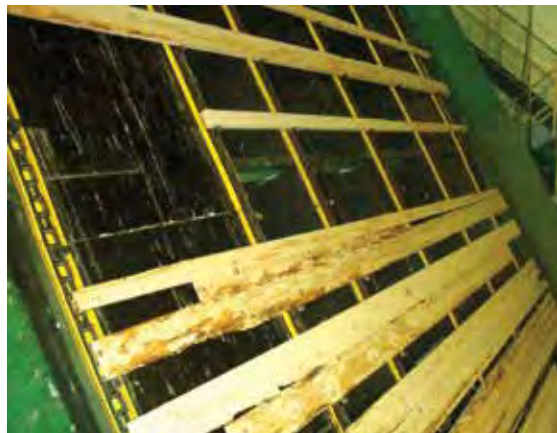

# CHAIN CHANNEL PROFILES

Prolong Chain Life

Reduce Noise

Reduce Power Consumption

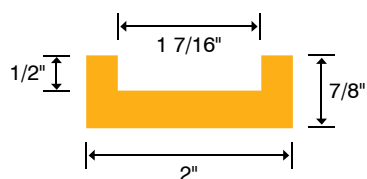

**Redco™ C2060 Channel**

Part #: R-13858

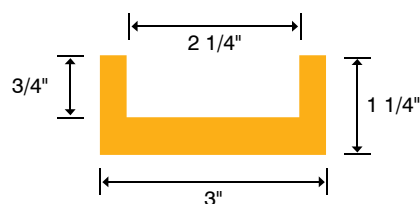

**Redco™ 81X Channel**

Part #: R-5007

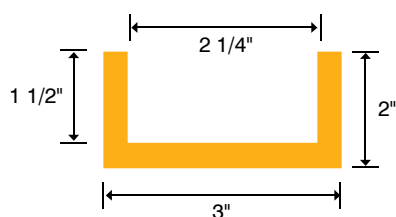

**Redco™ 81X High-Side Channel**

Part #: R-9087

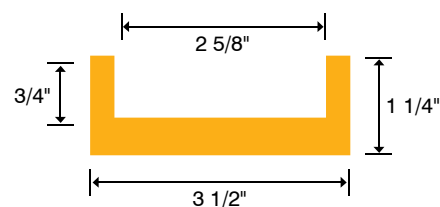

**Redco™ HD-81X Channel**

Part #: R-10576

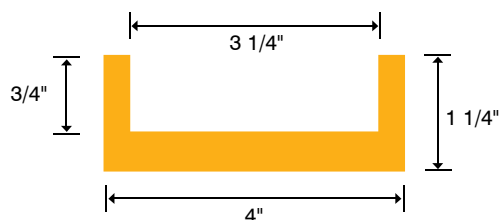

**Redco™ H78 Channel**

Part #: R-10148

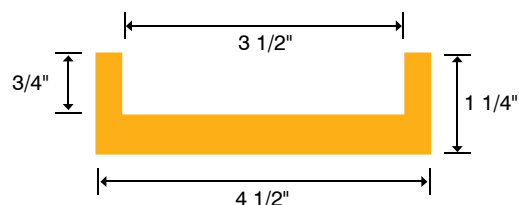

**Redco™ H82 Channel**

H82, WR78HD, WR82

Part #: R-4540

**Channel Stocked in 10' Lengths    Standard Color: Yellow**

Other colors, custom profiles, and specialty grades for excessive wear or high load applications are available.

# CHAIN CHANNEL PROFILES

Easy to Install

Lightweight

Custom Sizes Available

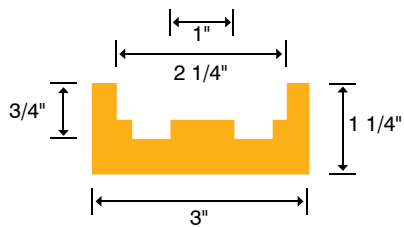

**Redco™ 81X E Trak Channel**  
Part #: R-5007-E

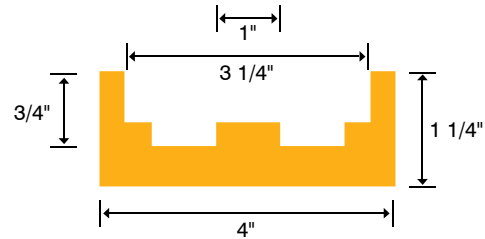

**Redco™ 81XHH/C188/H78**  
E Trak Channel  
Part #: R-10148-E

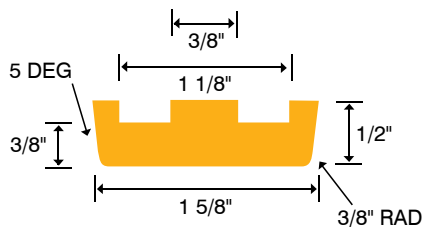

**Redco™ C2060**  
2" Steel Channel Insert  
Part #: R-28853

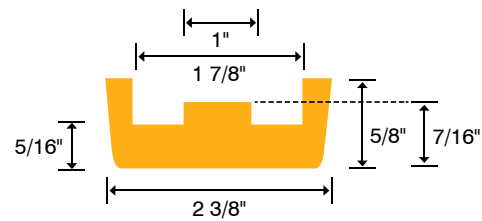

**Redco™ 81X**  
3" Steel Channel Insert  
(For 3 x 4.1lb Steel Channel)  
Part #: R-28855

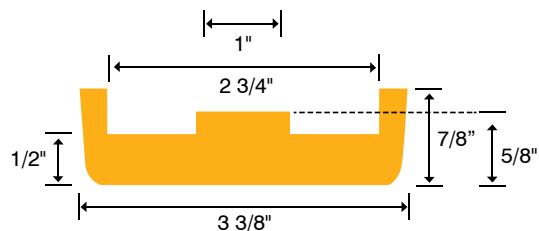

**Redco™ 81XHH**  
4" Steel Channel Insert  
(For 4 x 5.4lb Steel Channel)  
Part #: R-28857

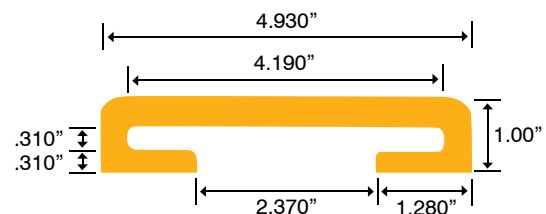

**Redco™ Flange Cap**  
Part #: R-32521

Custom Profiles Available on Request



# Redco™ OREGON BENDS

Description	Diameter
2" Channel	8" Oregon Bend
2" Channel	10" Oregon Bend
2" Channel	12" Oregon Bend
2" Channel	14" Oregon Bend
2" Channel	16" Oregon Bend
3" Channel	8" Oregon Bend
3" Channel	10" Oregon Bend
3" Channel	12" Oregon Bend
3" Channel	14" Oregon Bend
3" Channel	16" Oregon Bend
3.5" Channel	8" Oregon Bend
3.5" Channel	10" Oregon Bend
3.5" Channel	12" Oregon Bend

Description	Diameter
3.5" Channel	14" Oregon Bend
3.5" Channel	16" Oregon Bend
4" Channel	8" Oregon Bend
4" Channel	10" Oregon Bend
4" Channel	12" Oregon Bend
4" Channel	14" Oregon Bend
4" Channel	16" Oregon Bend
4.5" Channel	8" Oregon Bend
4.5" Channel	10" Oregon Bend
4.5" Channel	12" Oregon Bend
4.5" Channel	14" Oregon Bend
4.5" Channel	16" Oregon Bend



## DID YOU KNOW?

In 1982, Redwood Plastics and Rubber was the first company in the World to extrude 4ft wide Redco UHMW sheets.





## Redco™ 750 CHANNEL/ANGLE

If UHMW channel or angle is being used to reduce chain and equipment wear and is bubbling, cracking or being replaced often due to heat, we have the perfect solution!

Redco™ 750 Chain Channel doesn't bubble, having a higher heat resistance, and lasts considerably longer which reduces maintenance and downtime. The channel can be molded to any size to suit any chain size or conveyor system configuration.

### CORE ADVANTAGES:

- Exceptional resistance to high heat
- Long Lasting
- Reduce Maintenance
- Suits any chain size
- Reduces chain wear



# Redco™ UHMW/PE CONVEYOR LINERS

Redco™ UHMW/PE's low friction coefficient and high resistance to abrasion make it a great choice for wear and material flow applications. Specialty liners are also available in premium grades.

## Ready to Install

- Our conveyor liners can come pre-drilled and ready for installation.



LIGHT DUTY
Thickness x Width
3/8"x3" (9.5mm x 76mm)
3/8"x4" (9.5mm x 102mm)
3/8"x6" (9.5mm x 152mm)
3/8"x8" (9.5mm x 203mm)
3/8"x12" (9.5mm x 305mm)
3/8"x18" (9.5mm x 457mm)
3/8"x24" (9.5mm x 610mm)
3/8"x36" (9.5mm x 914mm)
3/8"x48" (9.5mm x 1219mm)

HEAVY DUTY
Thickness x Width
3/4"x3" (19mm x 76mm)
3/4"x4" (19mm x 102mm)
3/4"x6" (19mm x 152mm)
3/4"x8" (19mm x 203mm)
3/4"x12" (19mm x 305mm)
3/4"x18" (19mm x 457mm)
3/4"x24" (19mm x 610mm)
3/4"x36" (19mm x 914mm)
3/4"x48" (19mm x 1219mm)

MEDIUM DUTY
Thickness x Width
1/2"x3" (12.7mm x 76mm)
1/2"x4" (12.7mm x 102mm)
1/2"x6" (12.7mm x 152mm)
1/2"x8" (12.7mm x 203mm)
1/2"x12" (12.7mm x 305mm)
1/2"x18" (12.7mm x 457mm)
1/2"x24" (12.7mm x 610mm)
1/2"x36" (12.7mm x 914mm)
1/2"x48" (12.7mm x 1219mm)

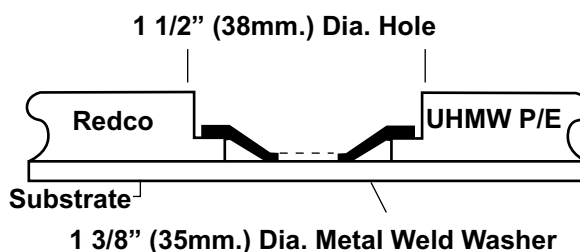

**Can be supplied pre-drilled to the recommended hole pattern, complete with metal weld washers.**

*Other sizes available upon request.*



# Redco™ SYNSTEEL CONVEYOR LINERS

Developed in 1982, **Redco™ SYNSTEEL** is the only "pulp friendly" UHMW/PE specifically for the pulp and paper industry.

- Specific gravity greater than 1
- Melt point greater than 160°C
- Activates metal detector

## Ready to Install

- Our conveyor liners can come pre-drilled and ready for installation.

LIGHT DUTY
Thickness x Width
3/8"x3" (9.5mm x 76mm)
3/8"x4" (9.5mm x 102mm)
3/8"x6" (9.5mm x 152mm)
3/8"x8" (9.5mm x 203mm)
3/8"x12" (9.5mm x 305mm)
3/8"x18" (9.5mm x 457mm)
3/8"x24" (9.5mm x 610mm)
3/8"x36" (9.5mm x 914mm)
3/8"x48" (9.5mm x 1219mm)

HEAVY DUTY
Thickness x Width
3/4"x3" (19mm x 76mm)
3/4"x4" (19mm x 102mm)
3/4"x6" (19mm x 152mm)
3/4"x8" (19mm x 203mm)
3/4"x12" (19mm x 305mm)
3/4"x18" (19mm x 457mm)
3/4"x24" (19mm x 610mm)
3/4"x36" (19mm x 914mm)
3/4"x48" (19mm x 1219mm)

MEDIUM DUTY
Thickness x Width
1/2"x3" (12.7mm x 76mm)
1/2"x4" (12.7mm x 102mm)
1/2"x6" (12.7mm x 152mm)
1/2"x8" (12.7mm x 203mm)
1/2"x12" (12.7mm x 305mm)
1/2"x18" (12.7mm x 457mm)
1/2"x24" (12.7mm x 610mm)
1/2"x36" (12.7mm x 914mm)
1/2"x48" (12.7mm x 1219mm)

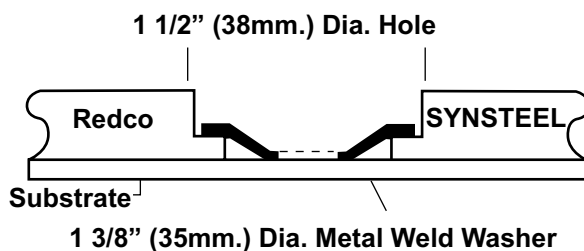

**Can be supplied pre-drilled to the recommended hole pattern, complete with metal weld washers.**

*Other sizes available upon request.*

# Redco™ SAW BLADE CARRIERS

**Redco™ Circular Saw Blade Carriers** prevent injuries to saw filers by allowing the saw blade to be carried safely and securely inside the carrier. They are also ergonomically designed to reduce injury and promote ease of use.

Constructed of highly durable, cut resistant **Redco™ Urethane** our saw blade carriers also prevent any damage to the blade teeth during blade changes which reduces maintenance and replacement costs.

**Redco™ Circular Saw Blade Carriers** are designed with a flat bottom to enable the blade and carrier to stand upright when placed on the ground. They are also fitted with a steel pin latch to ensure the carrier stays closed during transport.

- Steel pin latch
- Kraft pulp friendly
- Ergonomically correct
- Flex fit
- Increases safety

**Available Sizes: 16", 18", 20", 22", 24" & 26" (Custom sizes available)**  
**Standard Color: Safety Yellow**

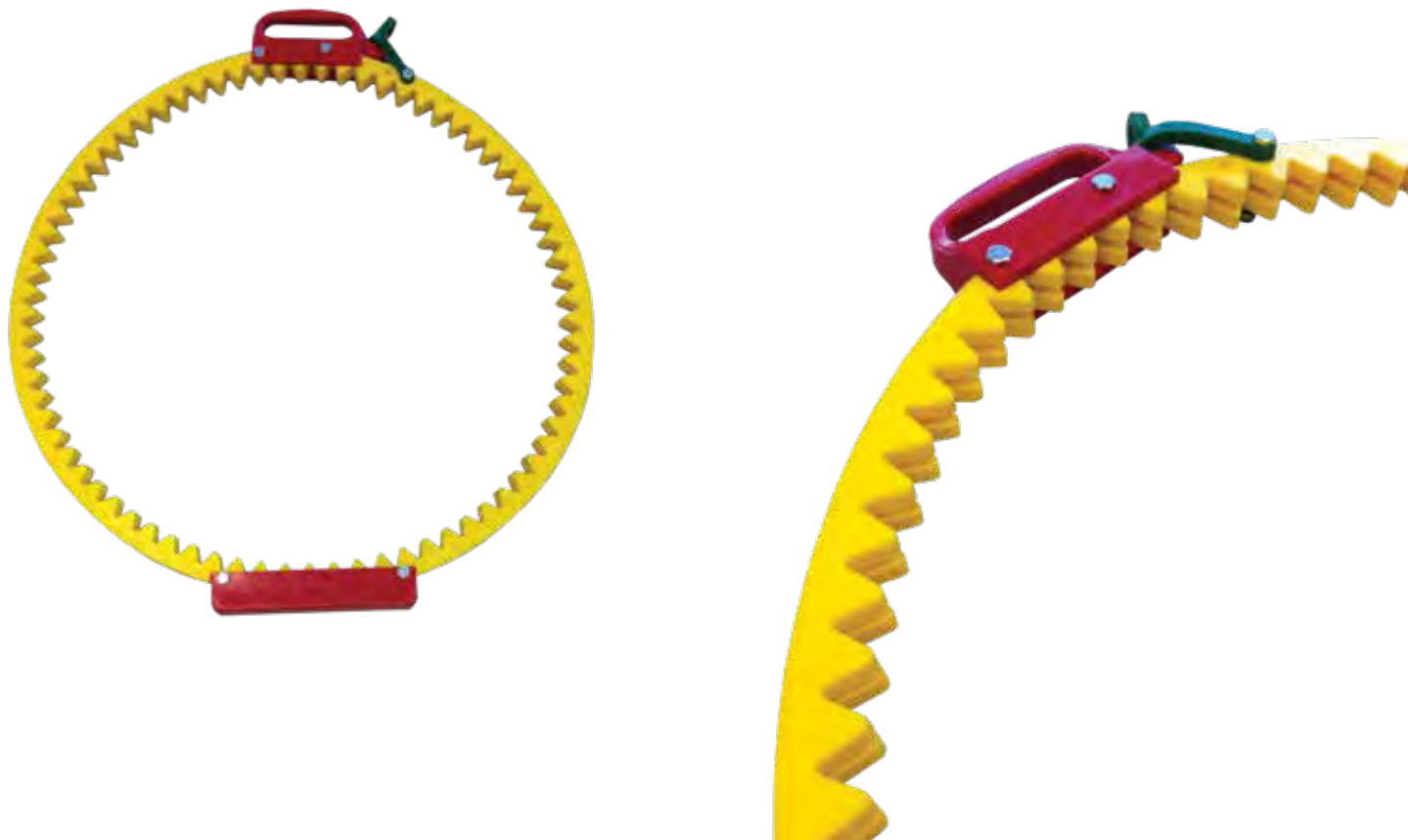

## Redco™ UHMW WEARPLATE

Used extensively to reduce wear, eliminate noise and cut installation cost, **Redco™ UHMW** polyethylene is a proven alternative to AR plate. **Redco™ Recycled UHMW** and premium grades, such as **Redco™ Titanium** and are also well suited to this application.

Available in full sheets, cut to size strips, or the various profile shapes. **Redco™ UHMW** wear plate is easy to install using plug welds.

- Standard sheet sizes are 4' x 10'. Custom sizes are available on request.
- Wearstrip is offered in standard 10 foot lengths and may be ordered by advising thickness, width and total length.
- Stock thicknesses are 1/8" through 3/4", increasing in 1/8" increments, 3/4" through 4" thick increasing by 1/4".
- Under 3/8" thick cannot be plug welded



“

Redwood Plastics and Rubber has been doing business with Weyerhaeuser Elkin for years. They have been a great resource for us. They have a large variety of products and a good knowledge of those products. Their pricing is competitive and their products are of good quality. I would recommend Redwood to other plants.

Weyerhaeuser Elkin NC

”



# Redco™ CONVEYOR FLIGHTS

REDUCE NOISE • LESS POWER CONSUMPTION • LOW COEFFICIENT OF FRICTION REDUCE WEAR ON CONVEYOR TROUGH • LONG LASTING



## Redco™ UHMW FLIGHTS

### FLAT BAR FLIGHTS

4" & 5" Heights  
16" - 36" Lengths  
Bolts to Standard Chain

A variety of styles and configurations available, including kraft pulp mill friendly. (SPS 2000)

## Redco™ UHMW CONVEYOR FLIGHT SLEEVES

### BOX & RECTANGLE FLIGHT

Available in 10' Lengths or Cut to Size  
Press Fit - No Retainers Required  
Presses Over 3" x 3" Box Tube  
or 1" x 3½" Flat Bar

A variety of styles and configurations available, including "PULP FREINDLY".

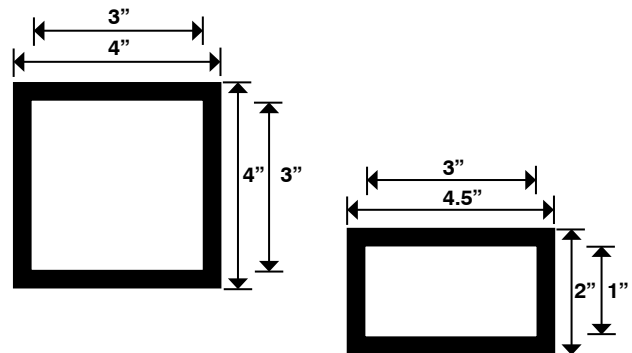

## Redco™ UHMW TANG CONVEYOR FLIGHT

4" & 5" Heights  
18" - 36" Lengths  
Reduces Bending  
5 Bolt Assembly  
Compatible with Square or Round Chain

- 50% THE WEIGHT OF CAST STEEL
- EASY TO REPLACE WORN OR DAMAGED SECTIONS
- EASY TO INSTALL

# Redco™ CONVEYOR FLIGHTS

Conveyor flights made of **Redco™ UHMW** are the ideal replacement for steel flights.

## Advantages:

- Strong - will not break
- Abrasion resistant - outlasts other materials
- Flexible, but returns to original shape
  - allows obstructions to pass.
- Low coefficient of friction
  - reduced power needs are required.
- Chemical resistant - will not rust or corrode
- Clean
- Economical
- Heat and cold resistant
- Moisture resistant
- Self-lubricating

## General Information:

- Material:
  - Redco™ UHMW, natural
  - Redco™ UHMW, recycled (repro) black
  - light safe for outdoor use.
- Operating Temperature Range -300° to +180°F



## When ordering, please specify:

1. Manufacturer or trade name of conveyor
2. Shape - round or flat bottom
3. Thickness of flight
4. Grade - natural, reprocessed black, crosslinked
5. Size - overall width & height (Send sample, drawing or tracing)
6. Center notch dimensions
7. Drilling - number of holes, location and size
8. Number of flights required
9. Chain - type of chain being used

Custom flights are available. Please send drawing and specifications.

## Redco™ SAW GUIDES

**Redco™** saw guides are manufactured from a long wearing graphite-filled phenolic material. These guides are compatible with oil, grease and solvents for lubrication and will stand up well under pressure and frictional conditions.

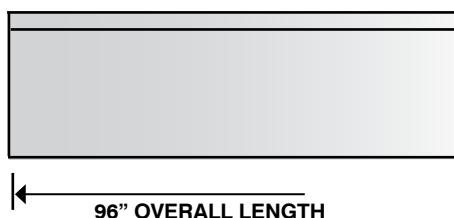
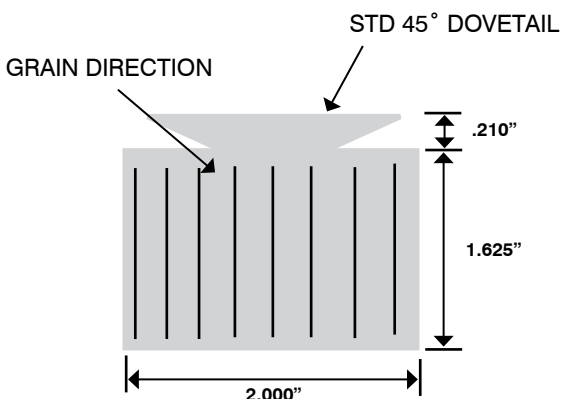

### DID YOU KNOW?

We introduced Redco Polyurethane Molded Chain Sprockets for H78 and 81X in 1980 and just a couple of years later, we developed the first Redco Polyurethane Carry-Over Wheel. (Opposite page)

- STANDS UP WELL UNDER PRESSURE AND FRICTIONAL CONDITIONS
- COMPATIBLE WITH OIL, GREASE, AND SOLVENTS FOR LUBRICATION
- CUT TO YOUR SPECIFICATIONS AND IS EASILY MACHINED

Length
6" (15.2cm)
7" (17.8cm)
8" (20.3cm)
9" (22.9cm)
10" (25.4cm)
11" (27.9mm)
12" (30.5cm)
13" (33.0cm)
14" (35.6cm)
15" (38.1cm)
16" (40.6cm)
60" (152.4cm)



## Redco™ CARRY-OVER WHEELS/ LUG LOADER

**Redco™ Urethane** coated carry-over wheels are commonly used in the wood products industry for board carry-over and lug loader applications. They are manufactured from high strength urethane materials, which give them impact resistance as well as light weight construction with a split design for easy installation. The soft urethane tire adds to their versatility in uses such as traction wheels, hold down wheels and feed rolls.

Carry-over wheels are available in a dual-hardness, complete engineered plastic design, or we can coat/re-coat existing steel wheels.

Some popular sizes are listed here. Other standard and custom sizes are also available.



**Specify Bore and Keyway as needed**

O.D.	FACE
10"	3"
12"	3"
12 1/2"	3"
13"	3"
13 1/2"	3"
14"	3"
14 1/2"	3"
15"	3"
16"	3"

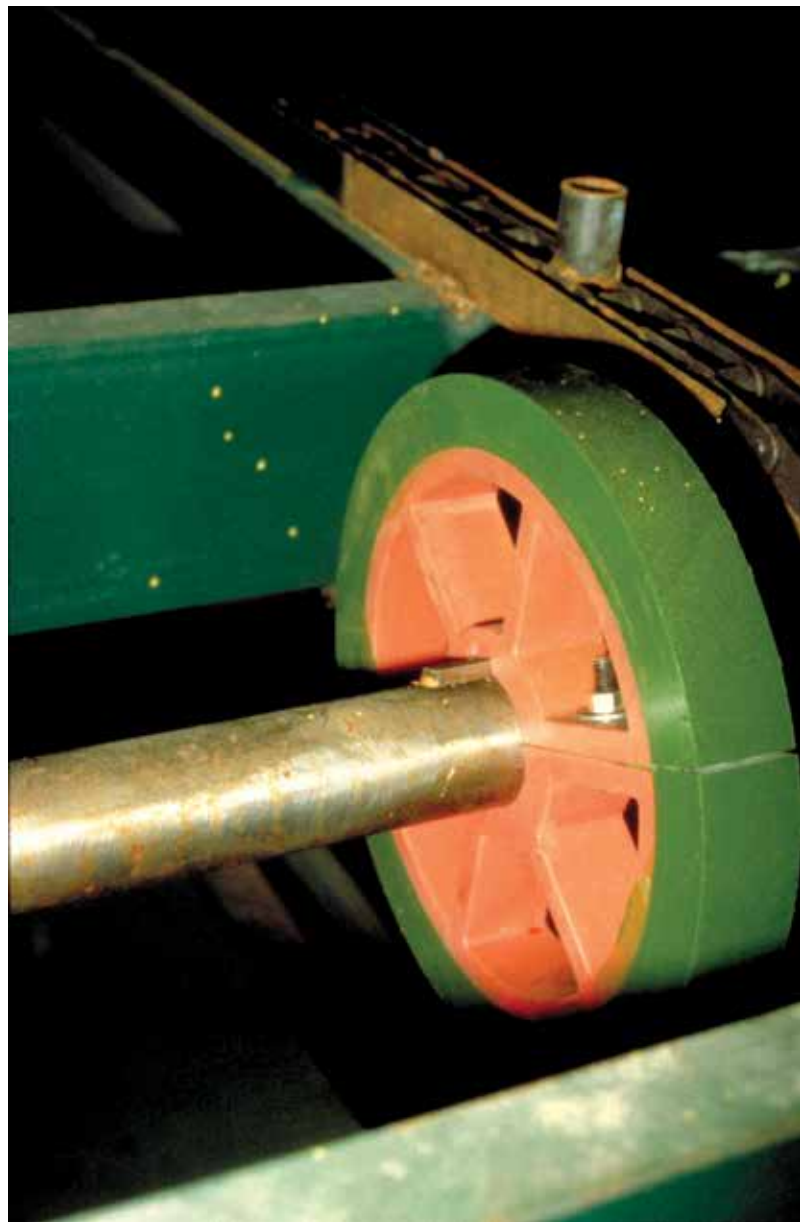

## Redco™ 9600 IMPACT BEARINGS

Introduced to deal with shock-load bearing applications, with its dual hardness polyurethane and fabricated steel outer shell, it has proven to outlast traditional bearings.

Primarily used in slow speed, high impact applications, such as hourglass rollers and log kickers, its four piece split construction makes it easy to install.

Other advantages include interchangeable components and a self-lubricated insert if the need arises.



Diameter	Material
1 15/16	Redco™ 750 or 750 SXL
2 7/8	Redco™ 750 or 750 SXL
2 15/16	Redco™ 750 or 750 SXL
3 7/16	Redco™ 750 or 750 SXL
3 15/16	Redco™ 750 or 750 SXL

“

“We have had a working relationship with Redwood since the beginning of 2008. Your sales representatives are always trying to help out, to get us to use different products that better suit our needs. They are always willing to stop by and look at an application if they think there is a better way to do it. I appreciate all of the hard work that they put forth and look forward to working with Redwood in the future.”

Interfor

”

# Redco™ J-HOOKS/SORTER HOOKS

Provides excellent elastomeric properties, with good abrasion resistance, high impact values and excellent wear.

**Redco™ 750** can be molded to any size, saving on costly machining for large part runs and also makes a perfect prototype material that is easy to machine.

Designed to replace aluminum, brass, bronze ZA-12 and babbitt.

**Durometer Hardness: 75D**

**Standard color: Red or yellow**



Many other styles available

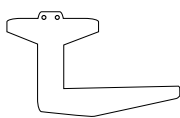

Style (A)

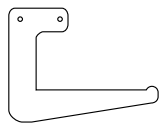

Style (B)

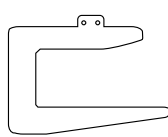

Style (C)

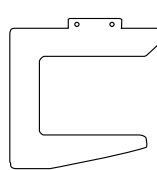

Style (D)

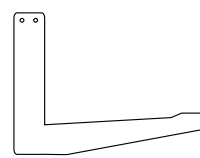

Style (E)

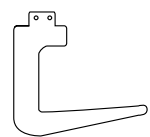

Style (F)



## DID YOU KNOW?

Today, J-bars, Sorter Hooks and Slider Blocks are essential to sorting equipment and in 1976, Redwood Plastics and Rubber developed the first Redco Polyurethane J-bar which reduced operating and maintenance costs and reduced product damage.





For more information on Redco™ products please call: 1 833 381 1195



## Redco™ SLIDER BLOCKS

**Redco™ UHMW** polyethylene offers a combination of high impact strength, excellent machinability and low surface friction with outstanding wear and corrosion resistance.

**Redco™ UHMW** reduces material hang ups and enhances material flow; increasing your production and your profits.

Also available in **Redco™ Polyurethane and Kraft Pulp Mill Friendly Grades.**

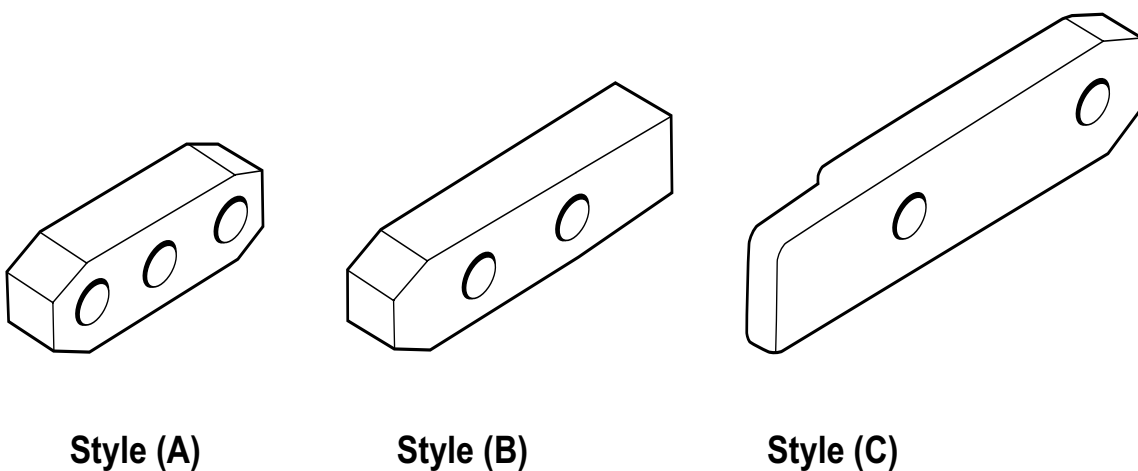

“

All your staff I speak to are very professional, very accurate on delivery dates and number one with product knowledge, regularly I try or order products I do not need and you knowledgeable staff always steer me to what we really need. I have a lot of very good vendors and very few GREAT ones, your staff is GREAT. We at Carrier greatly value our supplies and consider your company a valuable asset to us.

Carrier Forest Products Ltd.

”



## SPLIT BEARING BLOCKS

### Redco™ UHMW & URETHANE BEARING BLOCKS

Designed to handle light to medium loads in low speed applications, these split units offer the following:

- Easy assembly and installation
- Fit areas where clearance is a problem
- A variety of sizes in 2 or 4 bolt style

Stocked in **Redco™ UHMW** and **Redco™ 750 Polyurethane**. Custom sizes available.

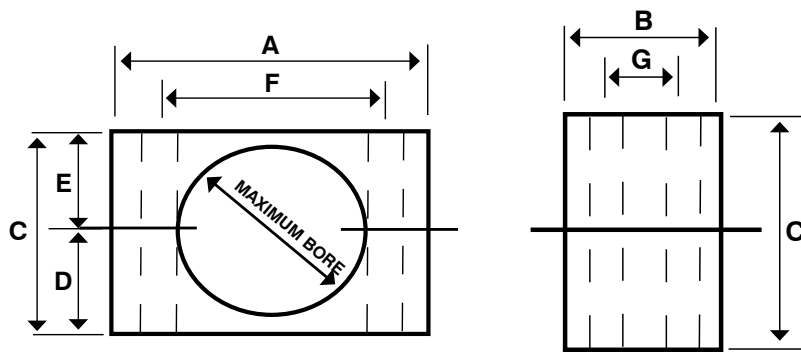

DIMENSIONS								
A	B	C	D	E	F	G	MAX BORE	NO. OF BOLTS HOLE SIZE
4.50	1.75	4.00	2.25	1.75	3.25		2.50	2 - 17/32
5.00	1.75	4.50	2.25	2.25	3.75		3.00	2 - 17/32
6.50	3.00	4.50	2.25	2.25	4.50	1.50	3.50	4 - 17/32
8.00	4.50	6.00	3.00	3.00	6.00	2.50	4.00	4 - 21/32
11.00	6.00	9.25	4.50	4.50	9.00	3.50	6.50	4 - 25/32



# Redco™ PUSHER LUGS

Proven under demanding conditions from southern heat to sub-zero temperatures, throughout the wood products industry, our pusher lugs are non-marking, shock absorbing and impact resistant. They are light weight, this helps to reduce system power consumption.

Pusher lugs are very economical and available in a variety of colors molded of 80A to 70D **Redco™ Urethane** or **Redco™ UHMW**. Steel inserts are also very popular.

If the following sizes below will not meet your needs, ask us about our extensive stock and our custom sizes.

## Extension Key S-Steel Insert

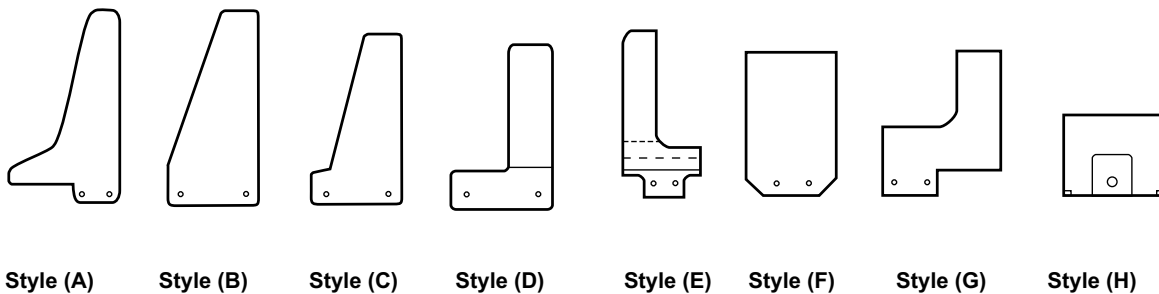

“

The customer service that I have received from Redwood Plastics is top notch. Whenever I request product quotes or technical specs, I always get either same day, or next day reply. Their product pricing is competitive with other vendors that I have available to buy from. The sales rep that calls upon us is most helpful in product selections, and also making us aware of new products and services that they offer. I've never had an issue with their shipping, delivery, or billing.

Weyerhaeuser

”



## DID YOU KNOW?

We have developed innovative materials specifically for the forestry industry including the only pulp friendly plastic material available; Synsteel™.

Other materials such as SPS2000™, Tuffkast™, Titanium™ and Deadplate™ are all hard wearing materials that were developed to optimize production and reduce maintenance.



For more information on Redco™ products please call: 1 833 381 1195

## Redco™ DIVERTER ARMS

Diverter arms are machined from impact resistant, low friction **Redco™ UHMW** polyethylene or molded **Redco™ Polyurethane**. They are typically black or orange in color and very economical. The light weight construction allows the arm to tip up and down quickly with low inertia. We have a large selection of molded sizes available.

If the following sizes below will not meet your needs, ask us about our extensive stock and our custom sizes.

Style	Thickness	X	Y
A	1"	1'-6 1/2"	9"
A	1"	1'-5 1/2"	8"
B	1"	1'-8 1/2"	8"
B	1"	1'-2 1/2"	8"
A	1"	1'-3 1/2"	9"
A	1"	1'-9 1/2"	9"
A	1"	1'-10"	9 1/2"
C	1"	1'-6 1/2"	6 7/8" (4 hole pattern)
A	1"	1'-6 1/2"	9"
B	1"	1'-8 1/2"	7 3/4"
A	1"	1'-8"	9 1/4"
C	1"	2'-0"	6 3/4" (2 hole pattern)
D	1 1/8"	2'-0"	5 1/2"
C	1"	1'-10"	7 1/2" (3 hole pattern)

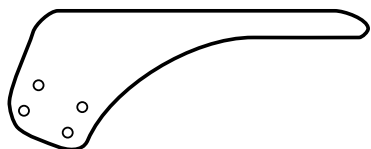

**Style (A)**

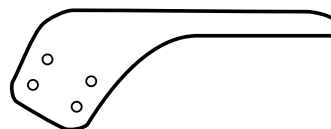

**Style (B)**



**Style (C)**

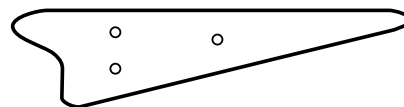

**Style (D)**

# Redco™ NYLON SHEAVES

**Redco™** Nylon cable sheaves & pulleys offer high load bearing capabilities (up to 4000 PSI), are light weight, self-lubricating and have a low co-efficient of friction. **Redco™** Nylon is easily machined, and is an outperforming and outlasting replacement for traditional metals and other plastics.

A heat stabilized formulation is available for applications with a maximum continuous operating temperature of 260°F.

- Ultimate compressive strength is 15,000 psi
- Bearing compressive strength is 4,000 psi
- Used as the industry standard for plastic sheaves or pulleys

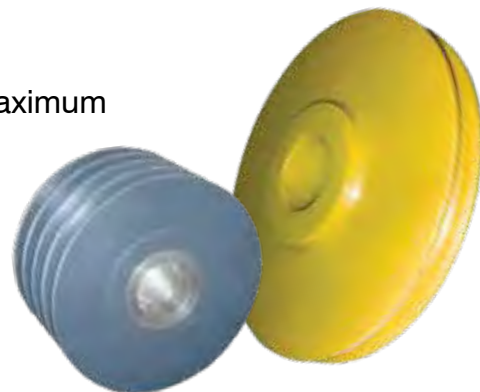

## Applications:

V-belt pulleys, v-ribbed pulleys, cable sheaves, cable belts, sorter sheaves, etc.

## Features & Benefits:

- Light-weight, 1/4 the weight of steel
- Extends cable life
- Quiet
- Long-lasting
- Non-corrosive
- Cost-effective
- Super strong Moly-filled Nylon
- Bearing lubrication not required
- Custom sizes available



Cable Diameter	Pitch Diameter	Pin Diameter	Hub Width
5/8"	7 5/8"	2-7/16"	1-9/16"
5/8"	10"	2-7/16"	1-9/16"
5/8"	12"	2-1/2"	2"
3/4"	10"	2-7/16"	1-11/16"
3/4"	12"	2-7/16"	1-11/16"
3/4"	12"	2-1/2"	2"



## Redco™ ROLLER NOSE DIVERTER GATES

**Redco™** roller chain diverter gates are extensively beneficial, unlike traditional materials. Plastic diverter gates are lightweight, quiet, cost effective and extend the life of the chain.

**Redco™** roller chain diverter gates can be made from **Redco™ 750 Polyurethane** or **Redco™ UHMW**. Both have roller nose ends for better wear, replacement simplicity, and overall better performance.

NOTE: If you already have an existing plastic diverter gate without roller nose ends and it is wearing out, we can supply you with an adaptor kit complete with all necessary hardware.

**STANDARD SIZE UNITS are for RC 80 chain.**  
**STANDARD LENGTHS: 27", 30" 33" and 36"**

Custom sizes are available.



“

We have been using Redco Deadplate cushioned back stops for 4 YEARS in four high impact extremely abusive log and cant handling applications and our maintenance time on repairs has greatly reduced. THANKS FOR COMING UP WITH A SOLUTION WITH A PROBLEM AREA

Roy O. Martin Lumber Company L.L.C.

”



## Redco™ TRIMMER LUGS

Trimmer lugs are non-marking, light-weight, chemical and corrosion resistant. Being manufactured from **Redco™ UHMW** provides the additional benefit of a part with a low coefficient of friction. The trimmer lug can be supplied as a complete unit, machined with proper running clearances to allow the lumber to flow easily across the decks on the cross-over rolls for end trimming.

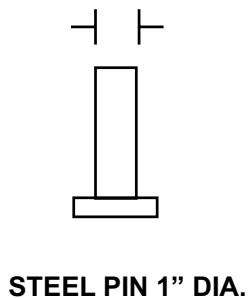
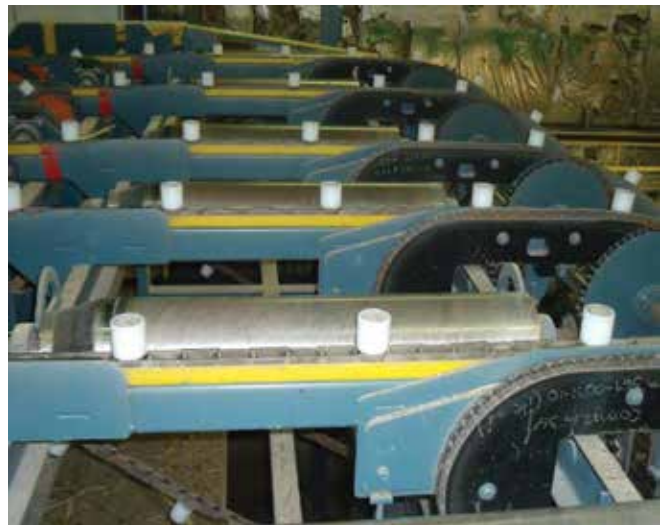
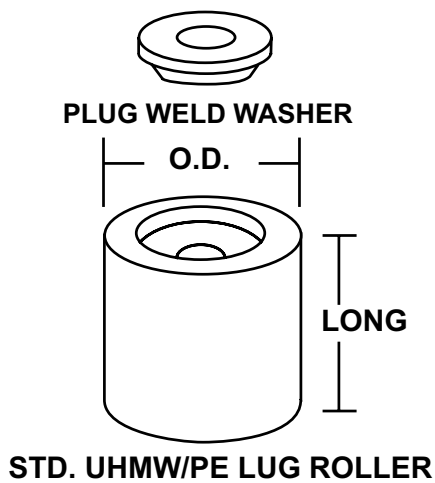

Size Chart	
option 1	2"-51mm. O.D.
	2"-51mm Long
option 2	2"-51mm O.D.
	2 1/2"-63.5mm Long
option 3	2"-51mm O.D.
	3"-76mm Long

**Other sizes available upon request**

## Redco™ CARRIAGE WHEELS

**Redco™** carriage wheels are designed as a replacement rim to reduce rail and wheel wear.

Manufactured from our premium grade material, **Redco™ Tuffkast**, this material has high load bearing capacity and good impact resistance.

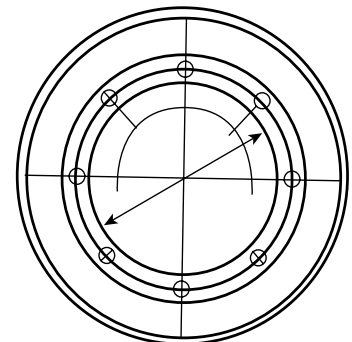
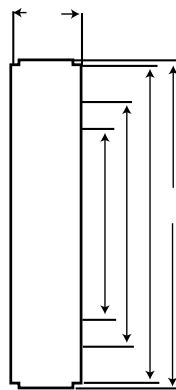
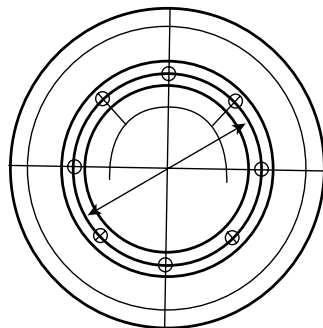
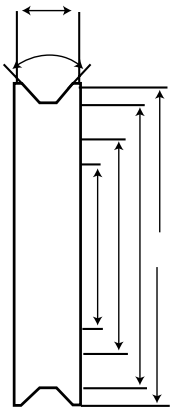

Standard Sizes	
V-Wheel	15 1/2" (394mm) O.D.
	8" (203mm) I.D.
	3 1/8" (79.4mm) WIDE
Flat Wheel	14" (356mm) O.D.
	8" (203mm) I.D.
	3 1/8" (79.4mm) WIDE

**Other sizes available upon request**



## SwitchSafe™ Redco™ CNS Knife Tool

Replacing knives on a chip n' saw shaft or chipping canter can be a difficult and time consuming job. Rotating the shaft to replace the extremely sharp blades that cut through gloves and hands can make it a dangerous job as well.

The Redco™ CNS Knife Tool, **SwitchSafe™**, saves you time and saves your hands from injury.



**SAFETY  
FIRST!!**

**SWITCH OUT CHIP N' SAW  
KNIVES QUICKLY AND EASILY  
WITHOUT INJURY!**



### **MATERIAL PROPERTIES**

- High impact strength
- Durable
- Lightweight



## Redco™ CHAIN CAP

**Redco™** chain cap was developed to minimize product damage due to chain markings on pull chains, landing tables, endings tables, etc. Maximize chain life and minimizing noise.

- Non-Marking
- Smooth Quiet Operation
- Low Coefficient of Friction
- Abrasion Resistant



## Redco™ HOSE PULLEYS

Our **Redco™ UHMW** hose pulleys offer a competitively priced alternative to conventional machined products. Many bore configurations are available to meet your specific requirements.

### Features

- Noise Reduction
- Corrosion Resistant
- Extends Life of Cable
- Reduced Wear on Hoses

### Sizes

- All other machined sizes available
- Available with a variety of bushing options

### Applications

- Cable Conveying Lines
- Forklift

### Materials

- UHMW
- Nylon



# Redco™ V-BELT SHEAVES

V-Belt sheaves are available in a wide variety of materials and configurations to meet your needs. Options such as multiple belt sheaves, or inserted bearings are available upon request. Listed below are a few of our standard sizes. Call us with your custom requirements.

Material Chart	
N	Natural UHMW
R	Reprocessed UHMW
O	Others Upon Request

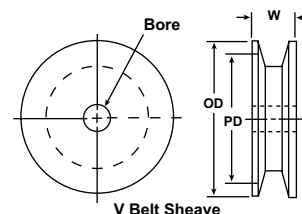

- Specify bore size (and keyway if required) when ordering
- Multiple groove, deep groove, and custom sheaves available upon request
- Please specify A or B belt

## V Belt Sheaves, A Belt

PD	OD	W	Stock Bore
3.40	3.75	1	1/2
3.60	3.95	1	1/2
3.80	4.15	1	1/2
4.00	4.35	1	1/2
4.20	4.55	1	1/2
4.40	4.75	1	1/2
4.60	4.95	1	1/2
4.80	5.15	1	1/2
5.00	5.35	1	1/2
5.20	5.55	1	1/2
5.40	5.75	1	1/2
5.60	5.95	1	1/2
5.80	6.15	1	1/2
6.00	6.35	1	1/2
6.20	6.55	1	1/2
6.40	6.75	1	1/2
6.60	6.95	1	1/2
6.80	7.15	1	1/2
7.40	7.75	1	1/2
8.60	8.95	1	1/2
9.40	9.75	1	1/2
11.00	11.35	1	1/2
12.40	12.75	1	1/2

## V Belt Sheaves, B Belt

PD	OD	W	Stock Bore
1.50	1.75	3/4	1/4
1.8	2.05	3/4	1/4
1.9	2.05	3/4	1/4
2.00	2.25	3/4	1/4
2.10	2.35	3/4	1/4
2.30	2.55	3/4	1/4
2.40	2.65	3/4	1/4
2.50	2.75	3/4	1/4
2.60	2.85	3/4	1/4
2.80	3.05	3/4	1/4
3.00	3.25	3/4	1/4
3.20	3.45	3/4	1/2
3.40	3.65	3/4	1/2
3.60	3.85	3/4	1/2
3.80	4.05	3/4	1/2
4.00	4.25	3/4	1/2
4.20	4.45	3/4	1/2
4.40	4.65	3/4	1/2
4.60	4.85	3/4	1/2
4.80	5.05	3/4	1/2
5.00	5.25	3/4	1/2
5.20	5.45	3/4	1/2
5.40	5.65	3/4	1/2
5.60	5.85	3/4	1/2
5.80	6.05	3/4	1/2
6.00	6.25	3/4	1/2
6.20	6.45	3/4	1/2
6.40	6.65	3/4	1/2
7.00	7.25	3/4	1/2
8.20	8.45	3/4	1/2
9.00	9.25	3/4	1/2
10.60	10.85	3/4	1/2
12.00	12.25	3/4	1/2

# Redco™ HANGER BEARINGS

Redco™ hanger bearings are available in various grades of Redco™ UHMW, Redco™ Nylon, Redco™ PTFE and Redco™ Polyurethane.

## Hanger Styles 20B, 26B, 28B, 220, 226, 326

ID	SD	SW	
1"	1-1/2"	1-1/16"	1-7/16"
1-1/4"	2-1/8"	1-9/16"	1-15/16"
1-1/2"	2-1/8"	1-9/16"	1-15/16"
2"	2-3/4"	1-9/16"	1-15/16"
2-7/16"	3-1/4"	2-3/8"	2-15/16"
3"	4"	2-3/8"	2-15/16"
3-7/16"	4-3/4"	3-1/8"	3-15/16"
3-15/16"	5-1/4"	3-1/8"	3-15/16"
4-7/16"	5-13/16"	4-1/4"	4-15/16"

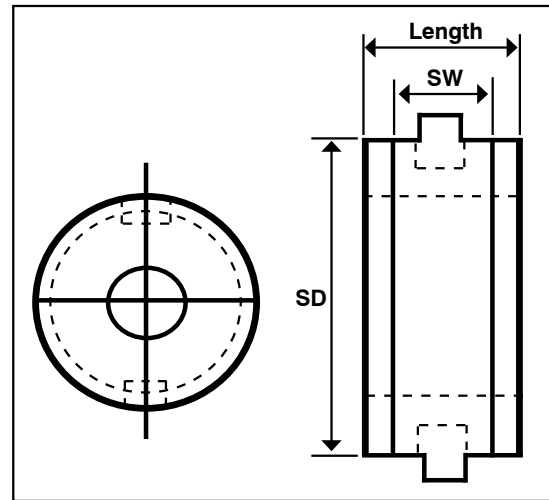

## Hanger Styles 20B, 26B, 28B, 220, 226, 326

ID	BD	Length
1"	1-1/2"	1-7/16"
1-1/2" (6" trough)	2"	1-15/16"
1-1/2" (9" trough)	2-3/8"	1-15/16"
2"	3"	1-15/16"
2-7/16"	3-11/16"	2-15/16"
3"	4-1/8"	2-15/16"
3-7/16"	4-11/16"	3-15/16"

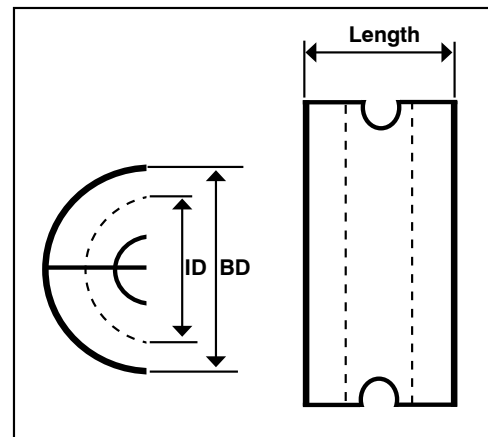

# Redco™ HANGER BEARINGS

## Hanger Styles 16B, 216, 216F, 230, 316

ID	SD	SW	RT	Length
1"	1-9/16"	1-1/8"	1"	1-7/16"
1-1/2"	2-1/4"	1-3/8"	1-3/8"	1-15/16"
2"	3-14/16"	1-5/8"	1-5/8"	1-15/16"
2-7/16"	4"	1-5/8"	2-1/8"	2-15/16"
3"	4-1/2"	2-1/8"	2-1/4"	2-15/16"
3-7/16"	4-7/8"	2-11/16"	2-7/16"	3-15/16"
3-15/16"	5-3/8"	3"	2-11/16"	3-15/16"
4-7/16"	6-3/16"	4-1/4"	3-1/4"	4-15/16"

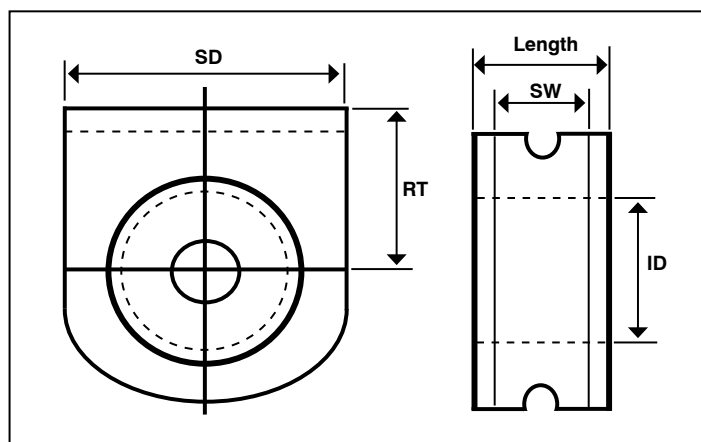

ID	OD	Length
1-1/2"	2"	1-5/16"
2"	2-1/2"	1-15/16"
2-7/16"	2-15/16"	2-15/16"
3"	3-1/2"	2-15/16"
3-7/16"	4-1/8"	3-15/16"

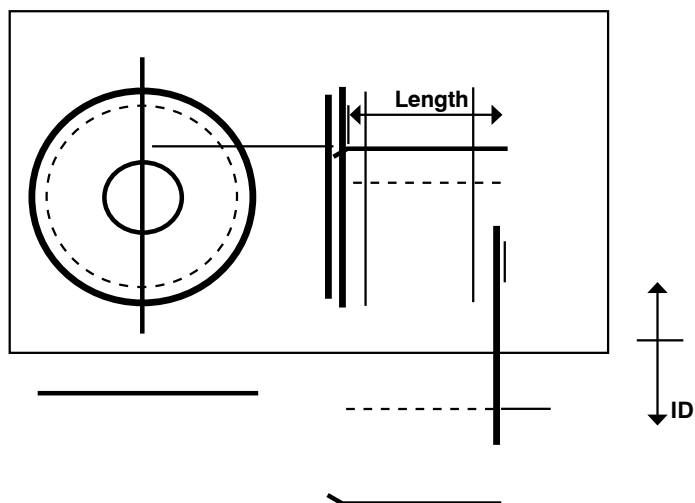



# Redco™ RUBBER & URETHANE ROLLERS

Redwood Plastics and Rubber provides roll Recovering, Regrinds & New Builds.

For end-users seeking a fast, skilled supplier to repair and re-build their existing rollers or OEM's looking for a reliable design partner for building new pulleys & wheels, Redwood Plastics and Rubber is the leading manufacturer of high quality lagged rollers.

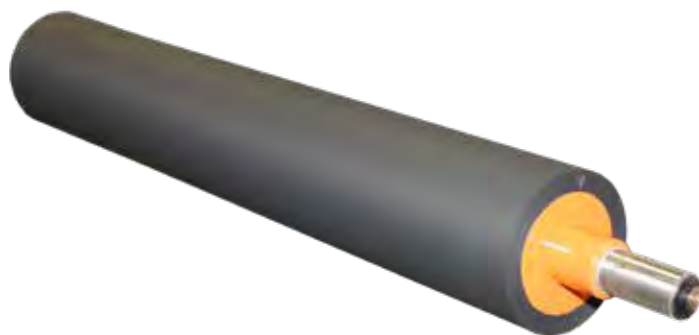

We offer a wide range of elastomer materials such as **SBR, Neoprene, EPDM, Urethane, Silicone, HNBR, Nitrile, Natural Rubbers and more!**

We can achieve the finish you require on nearly any of our materials in any durometer. We can offer anything from a Smooth Wrapped un-machined finish for conveyor applications all the way up to an Ultra Polished finish for packaging or film production.

- Cast Urethane up to 60" dia x 144", Longer or Larger Custom Sizes on Request.
- Rubber Lagging up to 46" dia x 167" Long.
- Fast Turnaround.  
Typically 12 – 14 Business Days
- Emergency Turnaround Delivery Available
- New Core Builds & Core Repairs
- New Crate Builds & Repairs
- Fiberglass Sleeve Regrinds & New Builds
- Material Analysis and Compound Matching
- Excellent Value vs. OEM Replacement
- Reusing Original Cores Saves You Money
- Great Technical Sales Support
- Standard TIR +/- 0.003"
- Standard Taper +/- 0.005"
- Standard Durometer Tolerance +/- 5
- Standard Durometer range 20A – 80D
- Non-Stick Coating Options.
- FDA Compliant Materials Available
- Anti-Static – Fire Retardant Options
- Crowing & Grooving Available

Glue Spreader Roller



Clipper Anvil Roller





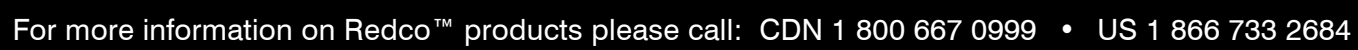



# Redco™ SHARK FIN BOARD TURNER

Shark Fin™ is designed to take singulated boards in lugs and automatically turn the pieces over on a grading table. Shark Fin™ is a “no touch system” eliminating board handling and injuries. The Shark Fin™ system fits 1 - 5 grader systems or electronic grading systems. Shark Fin™ can be easily coordinated into separate colors for easy identification so that each grader is always completely aware of which boards they are responsible for grading.

- To make split second, accurate decisions with no tolerance for error.
- Why submit your highly trained & skilled graders to board handling when they are paid to grade lumber not turn it?
- Shark fin™ automatic board turning systems are inertia driven to fit on existing, lugged grader chain tables!
- Shark fin™ is quick to install, has proven to reduce and eliminate injury & return injured graders to productive work.



“

I'm proud of this installation and happy to show it off!

We selected the sharkfin boardturner because of it's mechanical simplicity and it's 'hassle free' versatility. We are happy with this system, and we strongly recommend it. The payback on our board turner project was entirely based on lowering our WCB Premiums. With the shark fin, 6 of our senior graders could come back to work, saving us six figures a year.

Alliance Forest Products

”



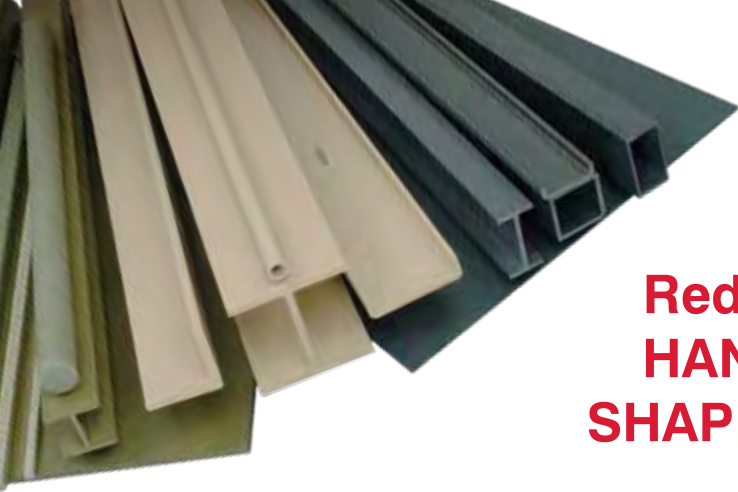

## **Redco™ FRP STRUCTURAL HANDRAILS, LADDERS, SHAPES & PLATE**

### **Replacing Steel, Aluminum and Wood**

**EXTREN®** is a proprietary combination of fiberglass reinforcements and thermosetting polyester or vinyl ester resin systems.

- **Corrosion Resistant**
- **Low in Conductivity — Thermally and Electrically**
- **Nonmagnetic — Electromagnetic Transparency**
- **Lightweight — Weighs 80% less than Steel**
- **High Strength**
- **Dimensional Stability**
- **Low Maintenance**
- **Custom Colors**

**EXTREN®** is produced in more than 100 standard shapes and all shapes have a surface veil to protect against glass fibers penetrating the resin surface in service and to increase corrosion and UV resistance.

**EXTREN®** is offered in three series designed for different environments and applications.

#### **SERIES 500**

An all-purpose series with a UV inhibitor. Color: Olive Green

#### **SERIES 525**

Fire retardant with a UV inhibitor. Color: Slate Gray (certain handrail and fixed ladder components in yellow)

#### **SERIES 625**

Premium series both fire retardant and highly corrosion resistant with a UV inhibitor. Color: Beige

EXTREN® is an official trademark of the Strongwell Corporation

# Redco™ FRP GRATING

**Redco™ FRP Grating** provides durability with extremely high strength and stiffness. Due to its high load capacity it can be used with confidence in applications where wide support spans are required.

**Redco™ FRP Grating** is also corrosion resistant and non-conductive making it ideal for applications where electrical current or chemicals may be present. **Redco™ FRP Grating** is low maintenance with a low cost of installation.

- Anti-slip
- Non-magnetic
- Impact Resistant
- Fire retardant
- Weatherproof
- Non-conductive
- Non-sparking
- Maintenance free
- Lightweight
- Non-skid surface
- Easy to install
- Corrosion resistant

A variety of specialty formulations are available for highly corrosive environments and where fire safety is a major concern.

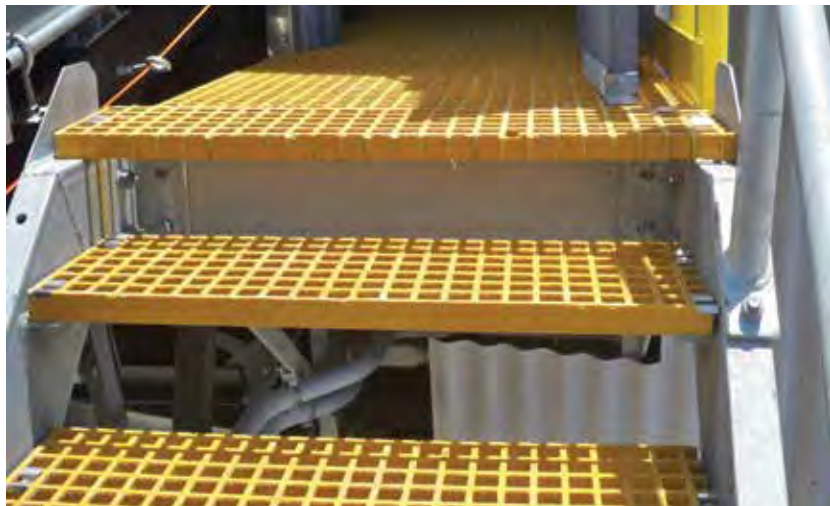
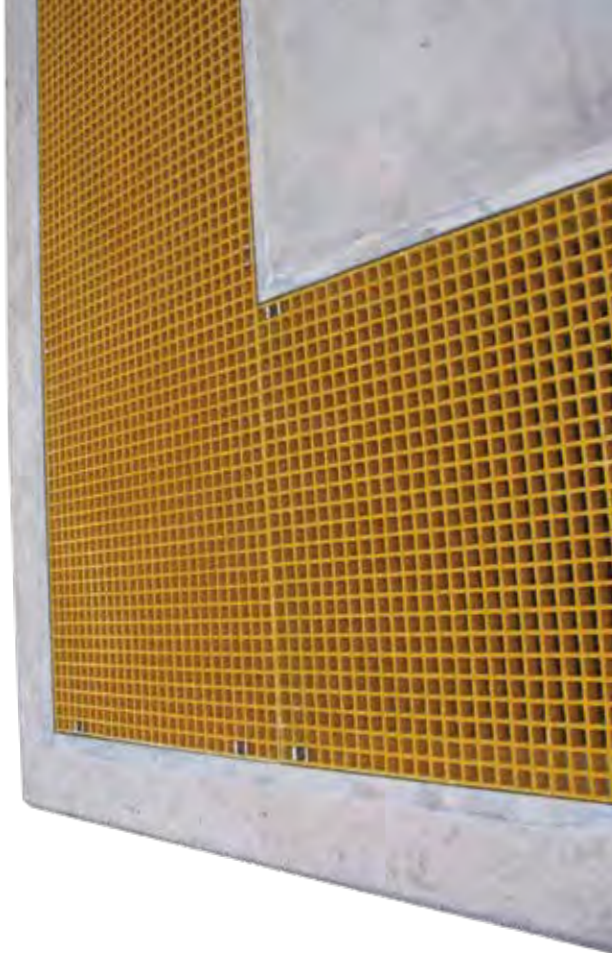





For more information on Redco™ products please call: 1 833 381 1195





## Redco™ PVC (Flexible Vinyl)

Redco™ PVC strip door and partitions contain heated or cooled air resulting in energy savings lost from unprotected openings. Dust, dirt and other contaminants also remain contained to reduce overall clean up costs. We offer a wide range of vinyl PVC for either pedestrian use and/or light traffic right up to heavy vehicle traffic such as fork-lift trucks.

Easy to clean, easy to replace and outstanding value. Redco™ Flexible PVC creates a safer and more productive work environment by providing protection from noise and harsh working environments while creating an easy to use, fully visible passageway for personnel, animals, product and machinery.

### Applications

- Swing and Strip Doors
- Temperature Control Room Dividers
- Conveyor Openings
- Welding Curtains
- Bin Enclosures
- Machine Enclosures
- Personnel Doors
- Loading Dock/Receiving Doors
- Storage Area Enclosures
- Cranway Enclosures
- Exterior Openings

### AVAILABILITY

- Roll, Strips, Curtains, Panels and Films
- Ribbed, Reinforced, Rounded Edges, Mat Surface
- Anti-UV, Anti-Insect, Anti-Static, Anti-Bacterial, Fire Retardant, Semi-Rigid and Colored Varieties





For more information on Redco™ products please call: 1 833 381 1195



# SAWMILLING & FORESTRY SOLUTIONS

## Redco™ UHMW

BEARING BLOCKS  
BEARINGS (LIGHT DUTY)  
BELT CHANNEL  
BIN BAFFLES  
CHANNEL  
CHIPPER SPOUTS  
CONVEYOR FLIGHTS  
DIVERTER ARMS  
DROP GATE ARMS  
FLIGHTS - BOX & PLATE  
HOOKS  
IDLER DRUM, CHAIN & FLIGHTS  
LINE BAR  
LUG ROLLERS  
LUGS  
METAL DETECTOR TROUGHS  
OREGON BENDS  
ROLLERS  
SAW COVERS  
SAW SHROUDS  
SAWDUST DIVERTERS  
SINGULATOR STAR WHEELS  
SKATE WHEELS  
SLATS  
SLIDER BLOCKS  
SLIDERS  
SORTER HOOKS  
SORTER LUGS  
SOUND DAMPENING CUSHIONS  
STRIPPING  
TIPPLE GATES  
TIPPLES  
TRIMMER LUGS  
WEAR PLATE  
WEAR STRIPS

## Redco™ SYNSTEEL® (Kraft Mill, Pulp Safe)

BELT CHANNEL  
BIN BAFFLES  
CARRIAGE KNEES  
CHANNEL  
CHIP SCREEN  
CHIPPER SPOUTS  
FLIGHTS - BOX & PLATE  
LINE BAR  
OREGON BENDS  
PRESS ROLL SLIDES  
SLATS  
SLIDER BLOCKS  
SLIDERS  
WEAR STRIPS

## Redco™ POLYURETHANE

BARKER BUSHINGS  
BARKER PARTS  
BEARING BLOCKS  
BEARINGS  
BELT SCRAPERS  
BIN SORTER PARTS  
BUMPERS  
BUSHINGS  
CABLE SHEAVE LINERS  
CANTER PARTS  
CARRIAGE PARTS  
CARRY OVER WHEELS  
CHAIN SPROCKETS  
CHANNEL  
CHIP-N-SAW PARTS  
COVERED FEED WHEELS  
CROSSFEED ROLLERS  
CUSHIONS UNDER  
BEARINGS  
CYLINDER SHOCK PADS  
DIVERTER ARMS  
DROP GATE ARMS  
FEED WHEELS  
FILING ROOM PARTS  
(ROLLERS, BELT, ETC.)  
FLEX COUPLINGS  
FORK LIFTS  
GEARS  
GRAPPLES  
GRINDER BELTS  
HOLD DOWN PRESS ROLL  
COVER AND BEARINGS  
HOOKS  
HOURGLASS ROLL  
BEARINGS  
IMPACT/ SHOCK PADS  
KICKER ARM PADS  
LOG DECK BEARINGS  
LUGS  
LUMBER CARRIERS  
MILL CHAIN SPROCKETS  
ROLLERS  
SEALS  
SHOCK & VIBRATION  
ISOLATION PADS  
SLIDER BLOCKS  
SORTER HOOKS  
SORTER LUGS  
SPLIT CARRYOVER WHEELS  
SPRINGS  
SPROCKETS

STACKER ARMS  
TIPPLE GATES  
TIPPLES  
TRAY SORTER PARTS  
TRIMMER LUGS  
WEAR SLIDES  
WEAR STRIPS, SHARP CHAIN

## Redco™ SVI PADS

BEARING MOUNT PADS  
EQUIPMENT ISOLATION  
IMPACT CUSHIONS  
SHOCK ABSORBERS  
SHOCK PADS  
STRUCTURAL ISOLATION

## Redco™ POLYCARBONATES

HEAVY EQUIPMENT WINDSHIELDS  
MIRRORED SHEET  
OPERATOR BOOTHS  
SAFETY ENCLOSURES  
SECURITY AREAS  
SIGHT GLASSES

## Redco™ ACETAL

AIR VALVE BARRELS  
ANTI-FRICTION PARTS  
BEARINGS  
ELECTRICAL COMPONENTS  
GEARS  
O-RINGS  
STEM SEALS

## Redco™ FRP

WALKWAYS  
STAIRS  
HANDRAILS  
LADDERS

## Redco™ Rubber

GASKETS  
SEALS  
ROLL COVERINGS

# SAWMILL SOLUTIONS

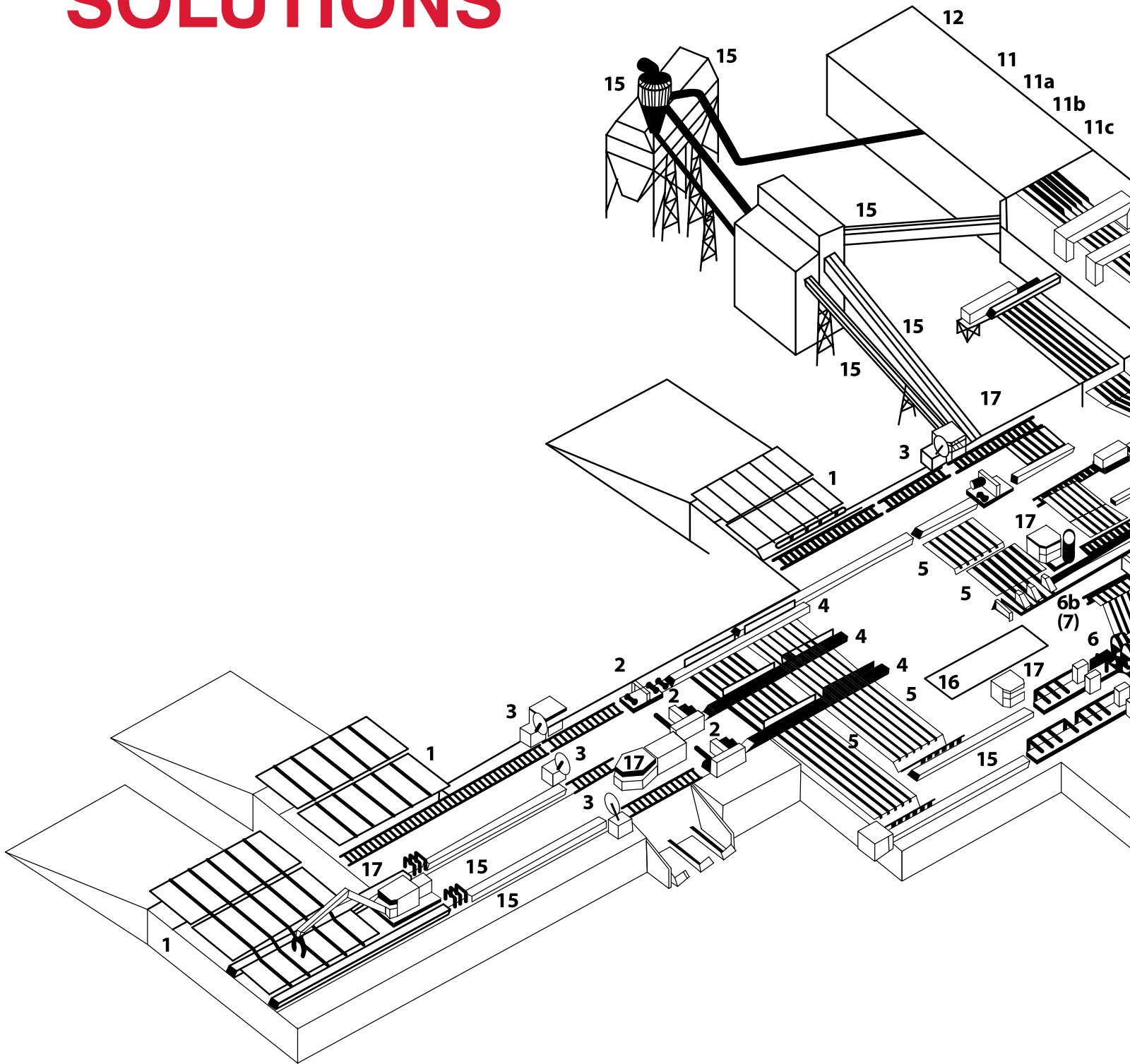





**REDWOOD**  
PLASTICS AND RUBBER

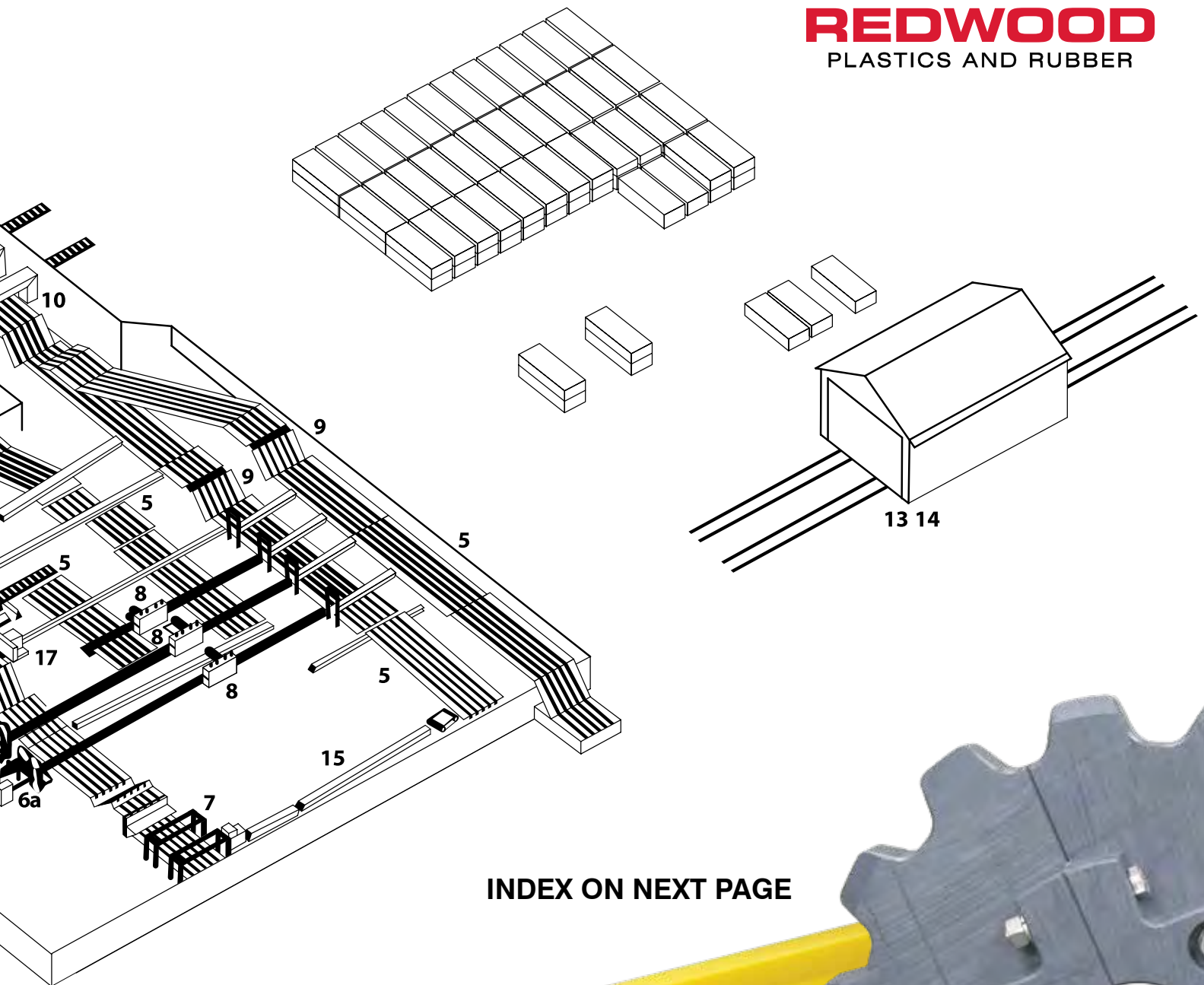

INDEX ON NEXT PAGE



# SAWMILL SOLUTIONS

## 1. LOG DECK

- a. UHMW Synsteel Wear Strips
- b. Bearings (9000 Series, 9600 Series)
- c. Redco 750 & 750XL Polyurethane Bushings
- d. Redco Shock Pads
- e. Urethane Dissipater Pads

## 2. DEBARKER

- a. Redco Shock Pads
- b. BL400 Phenolic Press Roll Bushings
- c. Synsteel Press Roll Slides
- d. Dampers, Rings & Bushings - Nylon or Tuffkast
- e. 9600 Bearings & Nylon Wheels - Rosserhead Type
- f. Nylon or Tuffkast Slides

## 3. CUT-OFF SAW

- a. UHMW Stripping
- b. Nylon or Tuffkast Bushings

## 4. LOG KICKERS

- a. Polyurethane/Tuffkast Bushings
- b. 9000 Series or 9600 Series Bearings
- c. Polyurethane Bumpers

## 5. TRANSFER DECKS

- a. Polyurethane Sprockets
- b. Polyurethane Tuffkast Bushings
- c. UHMW or Synsteel Wear Strip and Channel

## 6. HEAD RIG - QUAD

- a. Phenolic Saw Guides, Scrapers
- b. Phenolic Bushings
- c. UHMW or Synsteel Slats
- d. Sharp Chain Wear Strips - Redco 750XL or

## Nylon PVM

- e. Shearboards - Phenolic or UHMW

## 6a. HEAD RIG - TWIN

- a. Phenolic Saw Guides, Scrapers
- b. Phenolic Bushings
- c. UHMW or Synsteel Slats
- d. Shearboards - Phenolic or UHMW

## 6b. HEAD RIG - CARRIAGE

- a. UHMW Sliders
- b. Urethane Bushings
- c. Carriage Knees Phenolic, Nylon, Tuffkast, Synsteel
- d. Carriage Wheels - Tuffkast
- e. Kicker Arm Pads - Redco 430 Urethane

## 7. RESAW - SEE HEAD RIG-PLUS

- a. Line Bar - UHMW or Synsteel

## 8. BOARD OR GANG EDGER

- a. Edger Plug - Phenolic
- b. Shear Boards - Phenolic or UHMW
- c. Tipples - Polyurethane or UHMW
- d. Bearings Blocks - Polyurethane or UHMW
- e. Cylinder Shock Pads - Redco 430 Polyurethane
- f. Cleavis Pins - Phenolic or Tuffkast

## 9. UNSCRAMBLER

- a. Channel or Wear Strip - UHMW or Synsteel

# SAWMILL SOLUTIONS

- b. Cams - UHMW
- c. Sprockets - Redco 750
- d. Oregon Bends - UHMW or Synsteel

## 10. TRIMMERS

- a. Trimmer Lugs - UHMW
- b. Saw Covers - UHMW
- c. Limit Switches - Nylon
- d. Tipple Gates - UHMW or Polyurethane
- e. Tipple Gate Nose Replacements Kits
- f. Carryover Wheels - New or Recover
- g. Sprockets - Idler, Drive or Adjustable Drive
- h. Channel, High Side & Regular 81X-UHMW
- i. Bumpers - Dead Plate

## 11. SORTERS - BIN

- a. Hooks, Lugs - Polyurethane, UHMW, Nylon
- b. Sorter Sheaves
- c. Bin Slide - UHMW
- d. Diverter Arms - Polyurethane, UHMW
- e. Slider Blocks - Polyurethane, UHMW or

Synsteel

- f. Bearing Blocks - UHMW, Polyurethane
- g. Wear Strip - UHMW
- h. Channel on take away chains - UHMW or

Synsteel

## 11a. SORTERS - PUSH

- a. Channel - UHMW or Synsteel
- b. Wear Strip - UHMW or Synsteel

## 12. STACKERS

- a. Wear Strip - UHMW or infeed, Synsteel on  
Take Away

- b. Stickers Arms - Polyurethane
- c. Sprockets - Polyurethane

## 13. KILN CARTS

- a. Bushings - Moly filled Nylon
- b. Thrust Washers - Moly filled Nylon

## 14. KILNS

- a. Kiln Fan Bearing - Phenolic, PTFE

## 15. CONVEYING SYSTEMS

- a. Flights - Box & Plate - UH, Synsteel
- b. UHMW, Chain & Flight Idler Drum
- c. Wear Strip - UHMW or Synsteel in chip lines
- d. Metal Detector Troughs - UHMW (formed)
- e. Chipper Spouts - UHMW or Synsteel
- f. Bin Baffles - UHMW or Synsteel
- g. Bin Liners - UHMW or Synsteel

## 16. FILING ROOM (under floor hatch)

- a. Grinder Cam followers - Tuffkast
- b. Grinder Belts - Redco 430 Polyurethane
- c. Saw Tooth Protector - 500' Coils
- d. Rollers - UHMW
- e. Grinder Finger Roller - Nylon

## 17. MISCELLANEOUS

- a. Vinyl Strip Door
- b. Convex Mirrors
- c. Acrylic & Polycarbonate Operator Booth  
Windows
- d. FRP Structural Platforms, Handrails and  
Grating





For more information on Redco™ products please call: 1 833 381 1195



# PULP AND PAPER & OSB SOLUTIONS

## Redco™ UHMW

BEARINGS  
CHAIN CONVEYOR CHANNEL  
LININGS  
CONVEYOR FLIGHTS  
CONVEYOR LININGS  
DOCTOR BLADES  
FOIL BLADES  
FORMING BOARDS  
LUG ROLLERS  
METAL DETECTOR TROUGHS  
SKATE WHEELS  
SLIDERS  
STORAGE TANK LINERS  
SUCTION BOX COVERS  
WEAR PLATE UNDER BELTS  
WEAR PLATE UNDER CHAINS

## Redco™ SYNSTEEL® (Kraft Mill, Pulp Safe)

CHIP SCREENS  
CONVEYOR PARTS  
CYCLONE LINERS  
FLIGHTS  
LINERS, BIN & CHUTE  
PADDLES  
SIDE LIFT WEAR PLATE  
WEAR PLATES

## Redco™ HI-VIZ UHMW

CONVEYOR LINERS

## Redco™ POLYURETHANE

BEARINGS  
BUSHINGS  
CARRY OVER WHEELS  
CHANNEL  
DESILTER CONES  
FEED WHEELS  
GEARS  
IDLER BEARINGS  
IMPACT/SHOCK PADS  
ROLL CASE BEARINGS  
ROLL COVERINGS  
SEALS  
CLEANER CONES  
SORTER HOOKS  
SPROCKETS  
WEAR PLATES  
WEAR SLIDES

## Redco™ SPS 2000

CHANNEL  
CHIP CONVEYORS  
CHIP/SAWDUST BINS  
CYCLONE LINERS  
WEAR PLATES  
WEAR STRIPS

## Redco™ SVI PADS

BEARING MOUNT PADS  
EQUIPMENT ISOLATION  
IMPACT CUSHIONS  
SHOCK & VIBRATION PADS  
STRUCTURAL ISOLATION

## Redco™ NYLON

BEARINGS  
BUSHINGS  
CARRIAGE PARTS  
DRYER ROPER SHEAVES  
GEARS  
KILN KART BUSHINGS  
SHEAVES  
VALVE SEALS  
WASHERS, SPACERS  
WEAR STRIPS

## Redco™ TUFFKAST

CARRIAGE PARTS  
IDLER BEARINGS  
KICKER BEARINGS  
LOG SINGULAR BEARINGS

## Redco™ PTFE (TEFLON) & TFE

BEARINGS (LIGHT DUTY)  
CONES  
GASKETS  
INSULATORS  
LANTERN RINGS  
LINERS  
NOZZLES  
PISTON RINGS  
SEALS  
VALVE SEGMENTS  
WEAR STRIPS

## Redco™ PHENOLIC

BARKER PARTS  
BEARINGS  
BUSHINGS  
CARRIAGE PARTS  
ELECTRICAL INSULATOR  
SLEEVES  
GEARS/PINIONS  
SAW GUIDES  
SCRAPERS  
SWITCHBOARD PANELS

## Redco™ POLYCARBONATES

HEAVY EQUIPMENT  
WINDSHIELDS  
MIRRORED SHEET  
OPERATOR BOOTHS  
SAFETY ENCLOSURES  
SECURITY AREAS  
SIGHT GLASSES

## Redco™ ACETAL

AIR VALVE BARRELS  
ANTI-FRICTION PARTS  
BEARINGS  
ELECTRICAL COMPONENTS  
GEARS  
O-RINGS  
STEM SEALS

## Redco™ POLYPROPYLENE

CONTAINERS  
DUCTS  
SPECIALIZED EQUIPMENT  
VALVE DISCOUNTS  
VALVE SEGMENTS

## Redco™ FRP

WALKWAYS  
STAIRS  
HANDRAILS  
LADDERS

## Redco™ Rubber

GASKETS  
SEALS  
ROLL COVERINGS

## 1. LOG DECK AND LIFT AREA

- a) Side Lift - Wear Plate
- b) Impact Bearings/ Bushings
- c) Shock and Vibration Pads
- d) Metal Detector Troughs
- e) Flanged Bushings - Side Lift
- f) Roll Case 9600 Bearings

## 2. GROUNDWOOD, BARKER AREAS AND PRIMARY BREAKDOWN

- a) Redco™ 9600 Bearings
- b) Shock & Vibration Pads (SVI Pads)
  - i) Bearing Mount Pads
  - ii) Equipment Isolation
  - iii) Impact Cushions
  - iv) Shock Absorbers
  - v) Shock Pads
  - vi) Structural Isolation
  - vii) Shims/ Spacers
- c) Pump - Bearings
- d) Gate Cylinder Parts
- e) Seals
- f) Specialty Rollers/ Feed Rolls
- g) Sawguides, Scrapers & Shear Boards
- h) Sprockets
- i) Log Singular and Kicker Bearings Tuffkast™
- j) Barker Parts
- k) Plugs for Stone Flanges
- l) Gear Box Split Bearings
- m) Press Slides, Deflector Rolls
- n) Crane Sheaves/ Bushings
- o) Carriage Parts (Primary Breakdown)
- p) Conveyor Parts Synsteel
- q) Operator Booth Windows
- r) Deadplate Bumpers
- s) Wear Plate Under Chain

## 3. CHIP DUMP, HANDLING AND SCREENING AREAS

- a) Chute and Bin Liners (Synsteel & SPS2000)
- b) Wear Plate Under Chains
- c) Idler Bearings (Tuffkast & Redco 750SXL)
- d) Belt Roller and Returns
- e) Hanger Bearings
- f) Chip Screens (Synsteel)
- g) Metal Detector Troughs
- h) Cyclone Liners
- i) Sight Glasses
- j) Belt Skirting

## 4. HOG FUEL AND STEAM PLANT

- a) Conveyor Liners and Wear Plate (Synsteel)
- b) Paddles and Flytes
- c) Electrical Insulator Plates
- d) Explosion Rings/ Seals
- e) Bearings and Bushings
- f) Chute and Bin Liners
- g) Electrical Insulator Sleeves

## 5. DIGESTOR AND FIBRE BREAKDOWN

- a) Seals and Lantern Rings
- b) Bearings, Bushings

- c) Scrapers
- d) Pump Parts

## 6. WASH PLANTS/ BROWN STOCK

- a) Seals, Spacers
- b) Bearings, Bushings
- c) Scrapers
- d) Open and Closed Centre Valve Segments
- e) Deckle Plate Assembly
- f) Agitator Bearing, Seals

## 7. SCREENING AND BLEACH PLANT

- a) Scroll Drive Bearing
- b) Pulp Cone
- c) Vacuum Filter Closed Segment
- d) Vacuum Filter Open Segment
- e) Seals
- f) Deckle Strip
- g) Sight Glasses

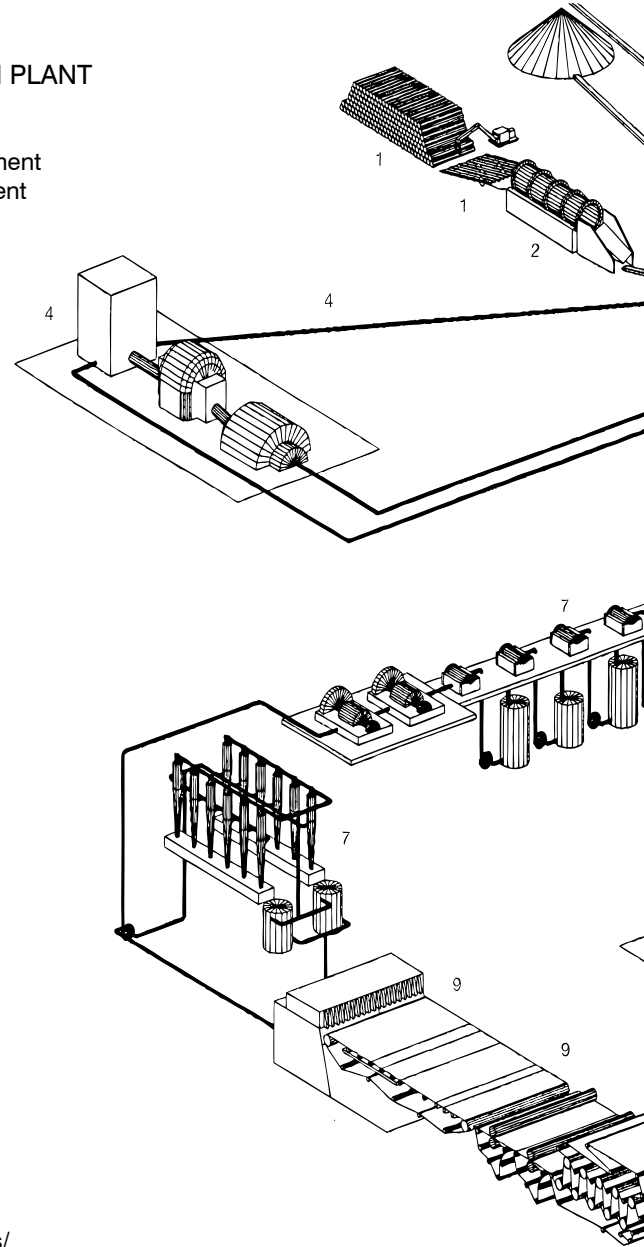

## MISC.

- a) Air Valve Barrels
- b) Anti- Friction Parts
- c) Electrical Components
- d) O-Ring Retainers
- e) Electrical Insulator Plates/ Switchboard Panels
- f) Gears/ Pinions
- g) Gaskets
- h) Piston Rings
- i) Safety Windows
- j) Security Areas
- k) Equipment Shields
- l) Mirrored Safety Sheet
- m) Convex Safety Mirrors
- n) Safety "Hazardous" Signs



# PULP AND PAPER & OSB SOLUTIONS

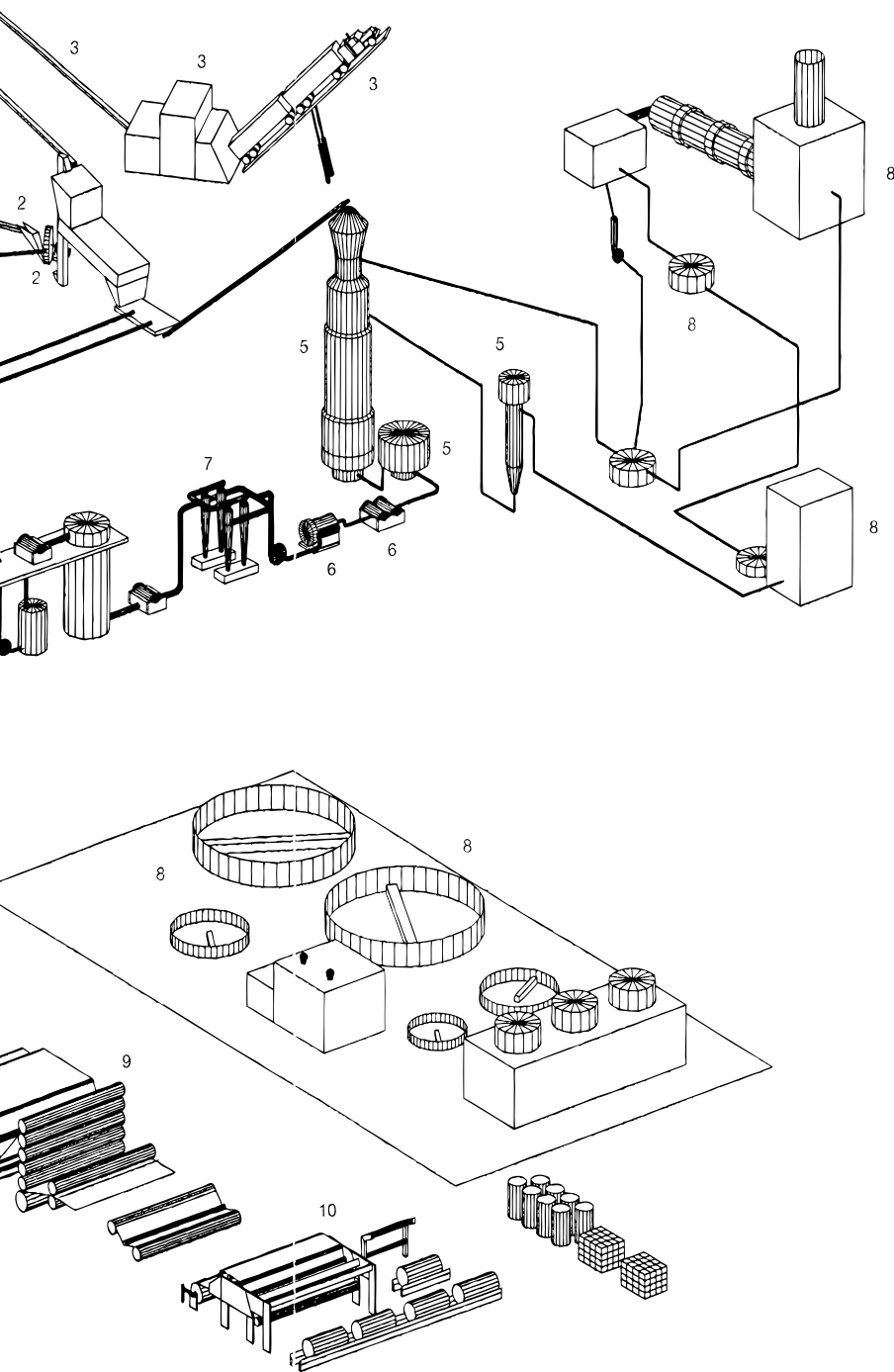

## 8. CHEMICAL AND CHEMICAL RECOVERY AREAS

- a) Valve segments/ valve discounts (Polypro-PTFE, ,Redco™ UHMW)
- b) Seals/ Rings/ Washers/ Strips
- c) Bearings/ Bushings
- d) Nozzles/ Cones (PTFE in Chlorines)
- e) Valve (Check Ball Type) PTFE Liner
- f) Piping - Visibility
- g) Spherical Ball and Guide Bushing/ Bearing
- h) Throttle Bushing, Pump Bushings, Agitator, Bushings/ Various
- i) Salt Cake Spreader Shoes (Salt Cake Filter)

## 9. PAPER MACHINE/ DRYERS

- a) Vat Roll Slide Bushings
- b) Seals
- c) Suction Box Covers
- d) Vibration Dampness (Shock Lines)
- e) Feed Wheels (Hold Down)
- f) Nylon Sheaves (Various Dia's 10" - 16"), Dryer Rope Sheaves
- g) Calendar Roll Sleeves
- h) Doctor Blades
- i) Foil Blades
- j) Deflector Blades
- k) Gears
- l) Agitator Bushings/ Various
- m) UHLE Box Covers
- n) Barrel Bushings on Agitating Doctor Blade
- o) Forming Boards

## 10. FINISHING DEPARTMENT

- a) Pulp Bale Press Slides
- b) Slitter Followers
- c) Clamp Truck Bushings
- d) Cutting Sticks
- e) Feed Wheel Covers
- f) Paper Wedges
- g) Pulp Bale Protectors
- h) Paper Roll Crimper Pods
- i) Forklift Mast Slides
- j) Core Sleeves
- k) Forklift Steering Axle Bushings



**REDWOOD**  
PLASTICS AND RUBBER





For more information on Redco™ products please call: 1 833 381 1195



# BIOMASS SOLUTIONS

## Redco™ UHMW

BEARINGS  
CHAIN CONVEYOR CHANNE  
CONVEYOR FLIGHTS  
CONVEYOR LINERS  
HOPPER LINERS  
SLIDERS  
STACKING CONES  
WEAR PLATE UNDER BELTS  
WEAR PLATE UNDER CHAINS

## Redco™ POLYURETHANE

BEARINGS  
BUSHINGS  
BOX FLIGHTS  
GEARS  
IMPACT/SHOCK PADS  
ROLL COVERINGS  
SEALS  
SPROCKETS  
WEAR PLATES  
WEAR SLIDES

## Redco™ SVI PADS

BEARING MOUNT PADS  
EQUIPMENT ISOLATION  
IMPACT CUSHIONS  
SHOCK & VIBRATION PADS  
STRUCTURAL ISOLATION

## Redco™ NYLON

BEARINGS  
BUSHINGS  
GEARS  
SHEAVES  
VALVE SEALS  
WASHERS, SPACERS  
WEAR STRIPS

## Redco™ TUFFKAST

BEARINGS

## Redco™ PTFE (TEFLON) & TFE

BEARINGS (LIGHT DUTY)  
CONES  
GASKETS  
INSULATORS  
LINERS  
NOZZLES  
SEALS  
VALVE SEGMENTS  
WEAR STRIPS

## Redco™ PHENOLIC

BEARINGS  
BUSHINGS  
ELECTRICAL INSULATOR SLEEVES  
GEARS/PINIONS  
SCRAPERS  
SWITCHBOARD PANELS

## Redco™ POLYCARBONATES

HEAVY EQUIPMENT WINDSHIELDS  
MIRRORED SHEET  
OPERATOR BOOTHS  
SAFETY ENCLOSURES  
SECURITY AREAS  
SIGHT GLASSES

## Redco™ ACETAL

ANTI-FRICTION PARTS  
BEARINGS  
ELECTRICAL COMPONENTS  
GEARS

## Redco™ POLYPROPYLENE

CONTAINERS  
DUCTS  
SPECIALIZED EQUIPMENT  
VALVE DISCOUNTS  
VALVE SEGMENTS

## Redco™ FRP

WALKWAYS  
STAIRS  
HANDRAILS  
LADDERS

## Redco™ RUBBER

AIRLOCK WIPES  
GASKETS  
SEALS  
ROLL COVERINGS



### 1. WOOD YARD/LOG DECK

- a) Grapple Bearings
- b) Redco™ Tuffkast-015 Log Singulator Bearings
- c) Redco™ 430/500 Couplings
- d) Redco™ Polyurethane Shock Pads
- e) Redco™ Tuffkast-015 Kicker Bearings

### 2. WOOD CRUSHING/SPLITTING

- a) Redco™ Shock Pads
- b) Redco™ Polyurethane Wear Components
- c) Redco™ UHMW Wear Components

### 3. DISTRIBUTION CONVEYOR

- a) Redco™ Titanium UHMW Angle Flights (Convey Product)
- b) Redco™ 750 Polyurethane Angle (Under Chain)
- c) Vibrating Conveyor Springs
- d) UHMW Belt Conveyor Liners
- e) Box Flights
- f) Redco™ CIP Hanger Bearings
- g) Screw Conveyor Auger Liners

### 4. PELLET MILL

- a) Airlock Wipes (High Heat Rubber)
- b) Redco™ Teflon Seal Set

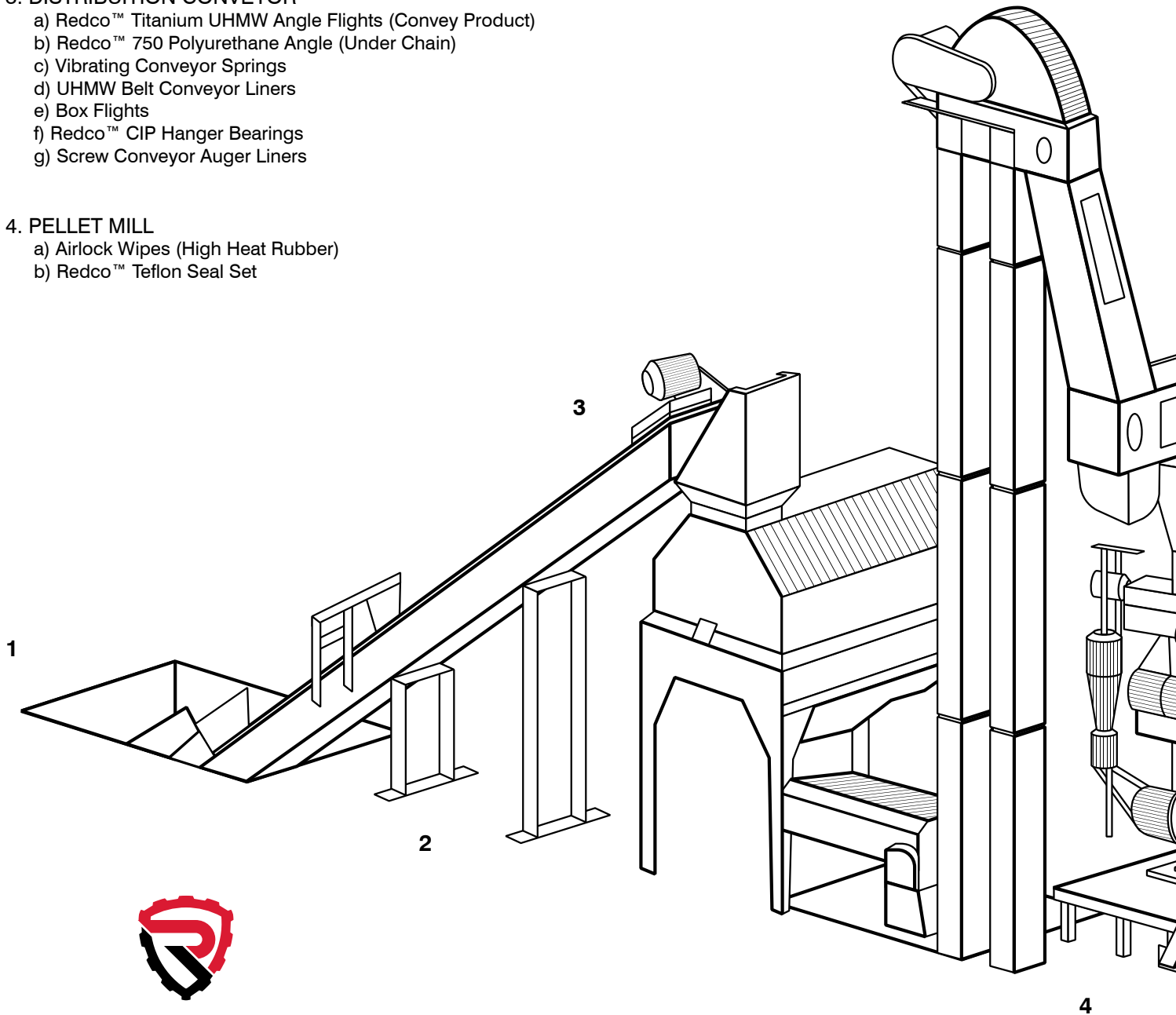

**REDWOOD**  
PLASTICS AND RUBBER

# BIOMASS SOLUTIONS

## 5. FINISHED PRODUCT FOR LOADING

- a) Redco™ X-Static UHMW Hopper Liners
- b) Redco™ X-Static UHMW Stacking

## 6. MISCELLANEOUS

- a) Redco™ FRP Grating (Cat Walks)
- b) Redco™ Anti-Fatigue Mats
- c) Redco™ Convex Safety Mirrors
- d) Redco™ Vinyl Strip Door
- e) Redco™ Polycarbonate

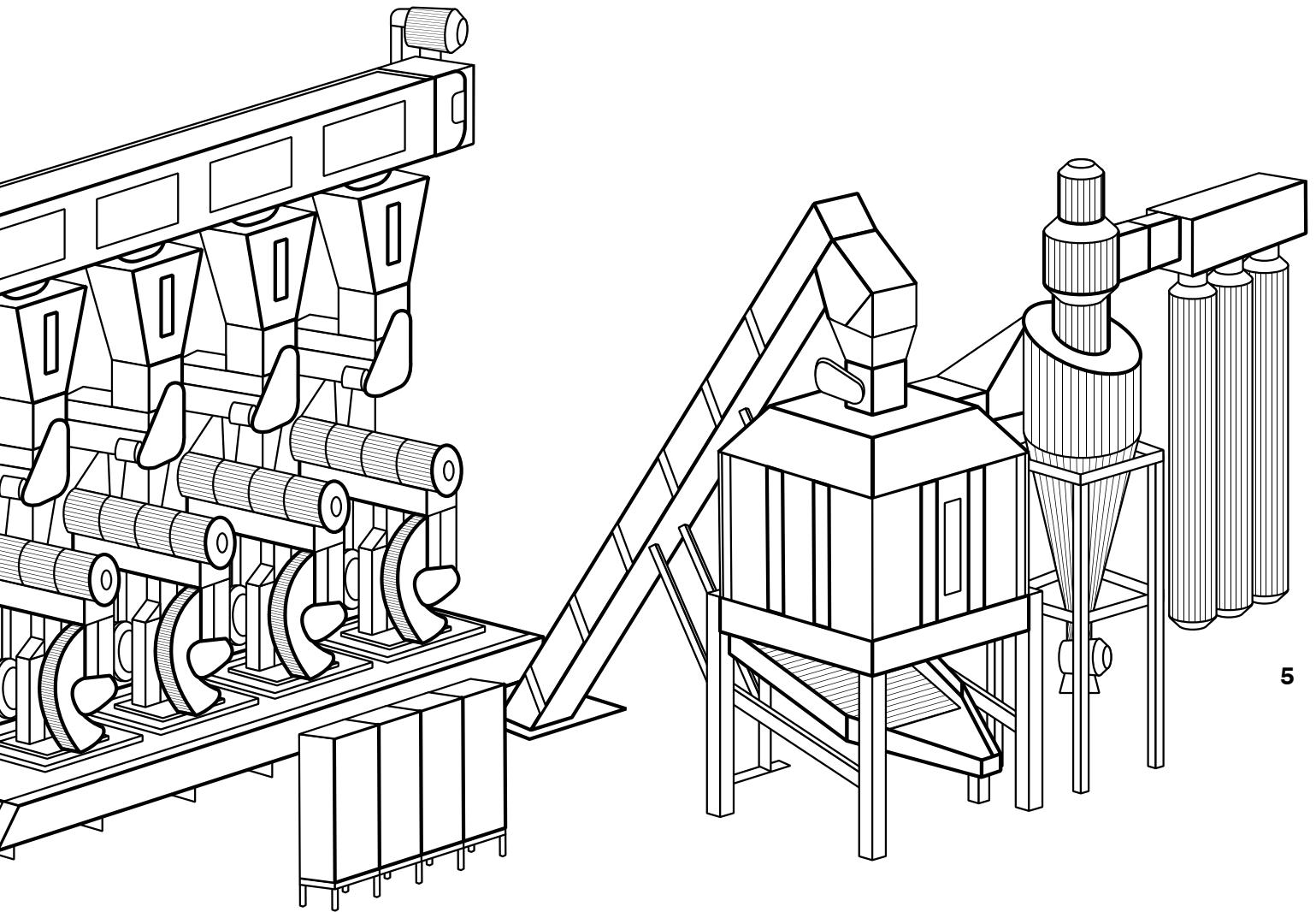

5



## Supplying More than Sheet, Rod and Tube

If the parts you require are not listed within this catalogue, please give us a call. Redwood Plastics and Rubber supplies stock plastic shapes and custom parts to solve a variety of problems including shock, abrasion, noise, wear and friction.

Many grades of industrial plastic and rubber are in-stock for quick delivery and custom parts are fabricated on a regular basis that replace steel, aluminum, and wood for longer wear life, decreased downtime and increased safety.

Contact our knowledgeable staff with any questions regarding industrial applications with plastics and rubber for the most cost-effective plastic solutions.

**1 833 381 1195**

email: [sales@redwoodplastics.com](mailto:sales@redwoodplastics.com)

**[www.redwoodplastics.com](http://www.redwoodplastics.com)**





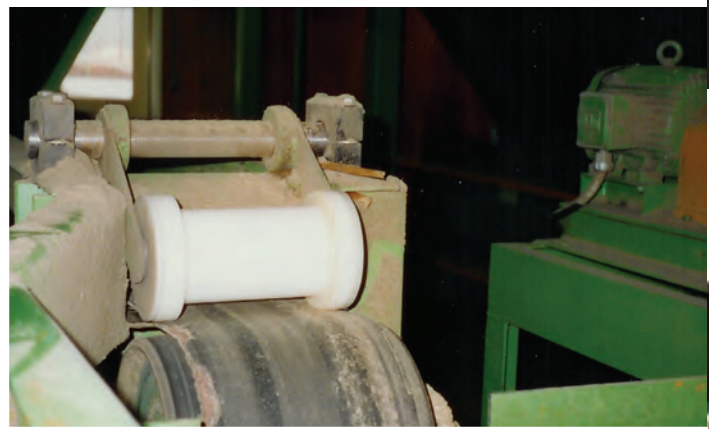

For more information on Redco™ products please call:

**1 833 381 1195**

email: [sales@redwoodplastics.com](mailto:sales@redwoodplastics.com)

[www.redwoodplastics.com](http://www.redwoodplastics.com)